

*FullView is the most innovative and comprehensive low-profile sign system available, featuring a slim 7/16" depth\*, a high degree of tamper resistance, and solutions for all interior signage needs and budgets.*

*Winner of an award for Design Excellence by the Industrial Designers Society of America, FullView is well-engineered and has been proven in facilities around the world.*

*FullView is also compatible with the Elements 2 range of decorative shapes and finishes vastly expanding the design options available.*

*\* Large Assembly (LA) modules feature a 5/8" depth.*



FullView is 100% modular and compatible with a wide range of insert and graphics options.

There are two edge profiles from which to choose and a host of other decorative options which make FullView an ideal solution for any interior environment.

FullView is available in five unique versions (described following) depending upon the project needs and budget. In addition, FullView is aesthetically compatible with APCO's Accord 15 modular sign system thus truly making it a Total System Solution.

### Frame Profiles

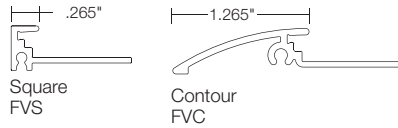

### Frame Finishes

*Standard*  
Natural Satin Anodized

*Custom*  
Polyurethane Coated  
- 44+ standard colors  
- custom

### Standard Assembly

The original and most tamper resistant FullView option, the Standard Assembly features 1/8" thick insert material (typically a non-glare lens protecting a digitally printed display) and a frame with a concealed locking pin. Using a special magnet/suction cup tool, displays can be updated as needed. By incorporating an 1/8" thick rigid non-glare lens, the Standard Assembly FullView offers maximum display compression and clarity.

Patent Protected

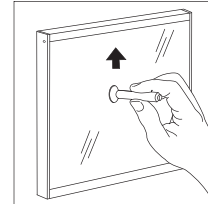
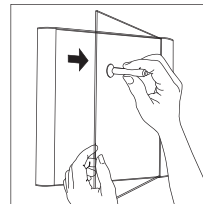
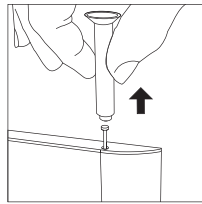

#### Vertical Configuration

A concealed Locking Pin, located in the upper right corner of the sign, is removed using a special Magnet Tool. Then, using the Suction Cup Tool provided, the insert is shifted to the right and pulled outward from the frame

#### Horizontal Configuration

A concealed Locking Pin, located in the upper left corner of the sign, is removed using a special Magnet Tool. Note: A Locking Pin is optional when using the FullView Horizontal Configuration. Then, using the Suction Cup Tool provided, the Sign Insert is lifted up and pulled outward from the frame.

### Top Access & Inner Access Assemblies

FullView's Top Access and Inner Access assemblies are ideal for situations where more frequent display updates may be needed. Signs feature a 1/16" thick non-glare lens that is not removable from the frame. With the Inner Access assembly, subsurface displays are removed with a sticky note or similar. The Top Access assembly lens features a thumb slot for easy removal of displays.

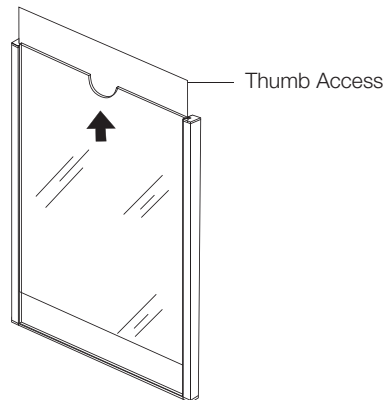

#### Top Access Assembly

A Thumb Slot at the top of the non-glare lens makes display updates fast and easy.

Maximum display size for the Top Access Assembly is 17"h x 11"w.

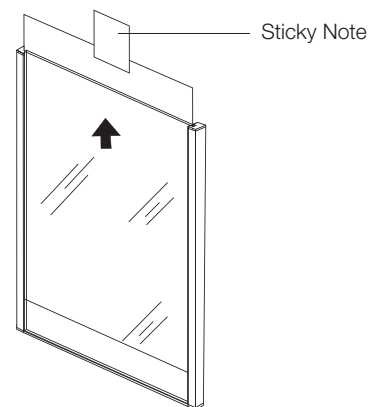

#### Inner Access Assembly

Displays are changed by inserting a sticky note or similar between the display and non-glare lens, applying pressure to create a bond between the sticky note and the display and then pulling the display up/out of the frame.

Maximum display size for the Inner Access Assembly is 17"h x 11"w.

## E-Series Assembly

The FullView E-Series features the same aluminum frames and profiles as the Standard Assembly but uses 1/16" thick flexible inserts (vs. the 1/8" thick rigid inserts of the Standard Assembly) which flex-in and flex-out of the frame via a Suction Cup Tool. E-Series frames do not incorporate a concealed security pin but offer a high degree of tamper resistance nonetheless.

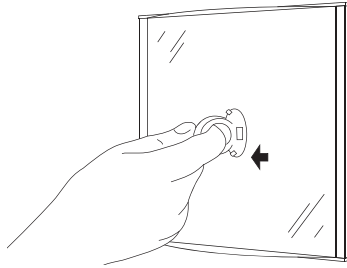

A Suction Cup Tool is used to pull the flexible sign insert directly outward from the frame.

Maximum display size for E-Series assemblies is 17"h x 11"w.

## Large Assembly

The FullView Large Assembly is an expansion of the FullView System which allows for larger display sizes up to 36" x 60" and beyond.

Frames feature a 5/8" depth and offer two aluminum profile options, Square and Radius.

### Frame Profiles

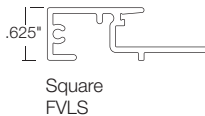

Square  
FVLS

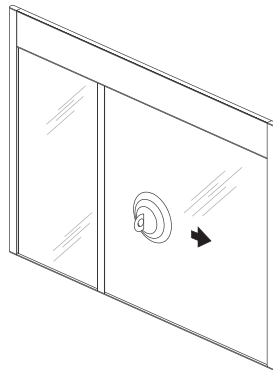

### Vertical Configuration

*(edge profiles on left/right of frame)*

Frames feature concealed spring mechanisms in the right aluminum profile which allow the 1/8" thick non-glare lenses to shift right and then pull outward using a Large Suction Cup Tool (shown above).

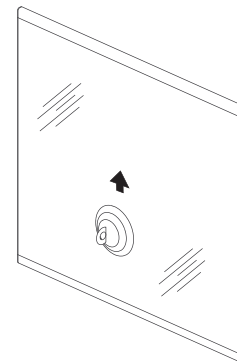

### Horizontal Configuration

*(edge profiles on top/bottom of frame)*

Lenses are removed from the frame with a Suction Cup Tool using a lift/pull technique. The Horizontal Configuration also offers a unique "4-Side Capture" feature enabling very large displays and adding extra tamper resistance.

## Stanchions & Kiosks

### Stanchion FV300

FullView Standard Assembly, Top Access, Inner Access or E-Series signs are affixed to APCO's light-weight FS300 Series stanchion providing a cost-effective and easily portable free-standing solution. The stanchion features a 42" 2-part aluminum post with a powder coated steel base for stability and can accommodate displays up to 17"h x 11"w. Displays can be angled, vertical, single-sided or double sided.

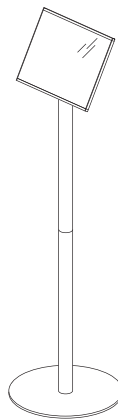

FV300 Stanchion

### Kiosk FVKS

The FullView Kiosk is a versatile free-standing sign & display solution allowing maps, directional information, meeting schedules, announcements and other information to be strategically placed within a facility.

Sizes range from 48"h x 11"w to 72"h x 22"w and display options include non-glare lenses protecting subsurface digitally printed graphics, decorative wood laminates, decorative metal laminates and more. Displays are secure yet easily updatable.

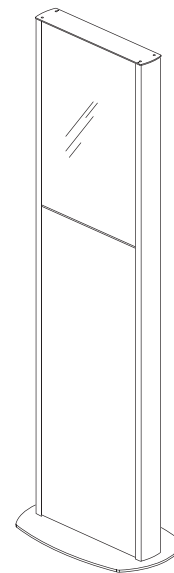

FVKS Kiosk

# Standard Assembly Vertical Configuration

## Wall Mount

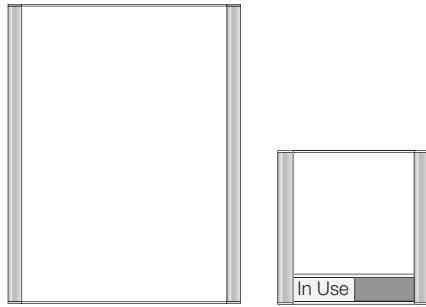

## Standard Display Options

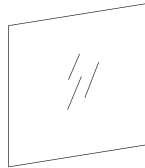

**ClearLens**  
(FVCL)  
1/8" Non-Glare Acrylic with Subsurface Digitally Printed Graphics

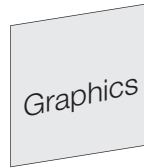

**Painted Plaque**  
(FVOP)  
1/8" Acrylic with Direct-Print Graphics

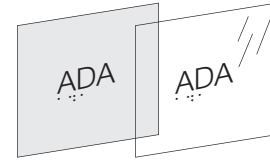

**ADA Plaque**  
(FV341A-DPT)  
1/8" Acrylic with UF-Cured, Direct-Print Raised Characters and Fully Domed Braille

## Installation/Mounting

Standard mounting is via vinyl tape (VT). Mechanical fastening via concealed holes within the frame's core is optional for small sizes and standard for large sizes as indicated by an "MF" suffix in the product code.



Perforated SignWord Paper Available for These Sizes.

## User Lettering Solutions Make Sign Maintenance Easy!

With APCO's FREE SignWord Pro software, enter your sign message and symbols using pre-established formats or your own custom layouts. Print the image on pre-colored SignWord paper or your own paper and the sign update is complete.

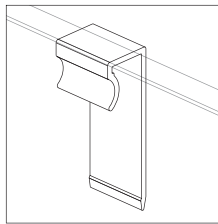

## Retention Clip

For large FullView modules, a discreet Retention Clip provides extra security in retaining the insert material within the frame. The clear matte plastic clip snaps onto the center of the aluminum closure extrusion at the top and bottom of the sign and is easily removed when display changes are necessary.

Width*	Height*	Frame Code	Insert Height	Insert Width
4"	4"	FV_0404(V)	4.08"	4.08"
4"	6"	FV_0604(V)	6"	4.08"
4"	8"	FV_0804(V)	8"	4.08"
6"	3"	FV_0306(V)	3"	6"
6"	4"	FV_0406(V)	4"	6"
6"	6"	FV_0606(V)	6"	6"
6"	7"	FV_0706(V)SL w/ Slider	6"	6"
6"	8"	FV_0806(V)	8"	6"
6"	10"	FV_1006(V)	10"	6"
8.5"	3"	FV_0385(V)	3"	8.5"
8.5"	4"	FV_0485(V)	4"	8.5"
8.5"	5.5"	FV_5585(V)	5.5"	8.5"
8.5"	6.5"	FV_6585(V)	6.5"	8.5"
8.5"	8.5"	FV_8585(V)	8.5"	8.5"
8.5"	9.6"	FV_9685(V)SL w/ Slider	8.5"	8.5"
8.5"	11"	FV_1185(V)	11"	8.5"
8.5"	14"	FV_1485(V)	14"	8.5"
11"	8.5"	FV_8511(V)	8.5"	11"
11"	11"	FV_1111(V)	11"	11"
11"	12"	FV_1211(V)	12"	11"
11"	14"	FV_1411(V)	14"	11"
11"	17"	FV_1711(V)	17"	11"
14"	8.5"	FV_8514(V)	8.5"	14"
17"	11"	FV_1117(V)	11"	17"
17"	14"	FV_1417(V)	14"	17"
17"	17"	FV_1717(V)MF	17"	17"
17"	22"	FV_2217(V)MF	22"	17"
22"	22"	FV_2222(V)MF	22"	22"
22"	30"	FV_3022(V)MF	30"	22"

\* All dimensions are nominal display sizes.

**Wall Mount**  
With ADA or Decorative  
Bottom Plaque

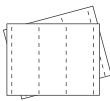
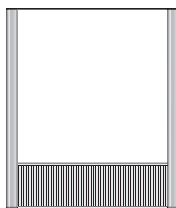
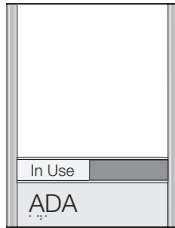
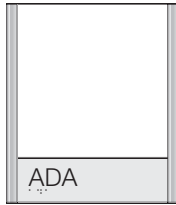

Perforated  
SignWord Paper  
Available for  
These Sizes.

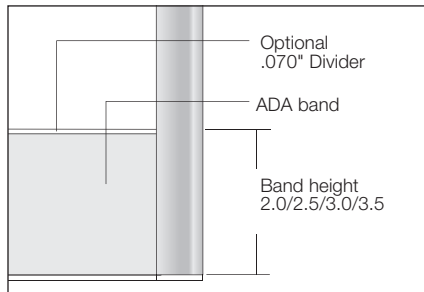

**ADA Plaque Divider**

A .070" anodized aluminum Divider Bar is an optional feature to separate the ADA plaque from the top display.

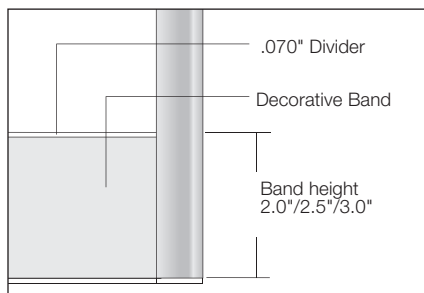

**Decorative Plaque Divider**

All Decorative Plaques feature a .070" anodized aluminum Divider Bar.

**Standard Display Options**



**ADA Bottom Plaque**  
(FV341A-DPT) without Divider  
(FV241A-DPT) with Divider  
1/8" or 1/16" Plaque with  
Direct-Print Raised Charac-  
ters/Braille, Permanently  
Attached to Frame

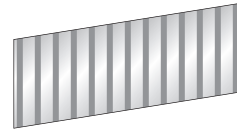

**Decorative Metal Plaque**  
(FVDM\_\_)  
DMP3 MicroPerf  
DMS4 Dimpled



**Direct-Print Decorative Wood Plaque**  
(FVDW\_\_)  
DWM1 Maple  
DWW2 Walnut  
DWO3 Oak  
DWC4 Cherry  
DWM5 Mahogany

**Frame Size \***

(Top Display)	Frame Code	Description
6"h x 4"w (4.08" x 4.08")	FV__0604(V)A2.0	Frame with 2" ADA Bottom Plaque
	FV__0604(V)AD2.0	Frame with 2" ADA Bottom Plaque w/ Divider
	FV__0604(V)DWD2.0	Frame with 2" Decorative Wood Plaque w/ Divider
	FV__0604(V)DMD2.0	Frame with 2" Decorative Metal Plaque w/ Divider
6"h x 6"w (4" x 6")	FV__0606(V)A2.0	Frame with 2" ADA Bottom Plaque
	FV__0606(V)AD2.0	Frame with 2" ADA Bottom Plaque w/ Divider
	FV__0606(V)DWD2.0	Frame with 2" Decorative Wood Plaque w/ Divider
	FV__0606(V)DMD2.0	Frame with 2" Decorative Metal Plaque w/ Divider
8"h x 6"w (6" x 6")	FV__0806(V)A2.0	Frame with 2" ADA Bottom Plaque
	FV__0806(V)AD2.0	Frame with 2" ADA Bottom Plaque w/ Divider
	FV__0806(V)DWD2.0	Frame with 2" Decorative Wood Plaque w/ Divider
	FV__0806(V)DMD2.0	Frame with 2" Decorative Metal Plaque w/ Divider
5.5"h x 8.5"w (3" x 8.5")	FV__5585(V)A2.5	Frame with 2" ADA Bottom Plaque
	FV__5585(V)AD2.5	Frame with 2" ADA Bottom Plaque w/ Divider
	FV__5585(V)DWD2.5	Frame with 2" Decorative Wood Plaque w/ Divider
	FV__5585(V)DMD2.5	Frame with 2" Decorative Metal Plaque w/ Divider
6.5"h x 8.5"w (4" x 8.5")	FV__6585(V)A2.5	Frame with 2.5" ADA Bottom Plaque
	FV__6585(V)AD2.5	Frame with 2.5" ADA Bottom Plaque w/ Divider
	FV__6585(V)DWD2.5	Frame with 2.5" Decorative Wood Plaque w/ Divider
	FV__6585(V)DMD2.5	Frame with 2.5" Decorative Metal Plaque w/ Divider
11"h x 8.5"w (8.5" x 8.5")	FV__1185(V)A2.5	Frame with 2.5" ADA Bottom Plaque
	FV__1185(V)AD2.5	Frame with 2.5" ADA Bottom Plaque w/ Divider
	FV__1185(V)DWD2.5	Frame with 2.5" Decorative Wood Plaque w/ Divider
	FV__1185(V)DMD2.5	Frame with 2.5" Decorative Metal Plaque w/ Divider
14"h x 8.5"w (11" x 8.5")	FV__1485(V)A3.0	Frame with 3" ADA Bottom Plaque
	FV__1485(V)AD3.0	Frame with 3" ADA Bottom Plaque w/ Divider
	FV__1485(V)DWD3.0	Frame with 3" Decorative Wood Plaque w/ Divider
	FV__1485(V)DMD3.0	Frame with 3" Decorative Metal Plaque w/ Divider
12"h x 11"w (8.5" x 11")	FV__1211(V)A3.5	Frame with 3.5" ADA Bottom Plaque
	FV__1211(V)AD3.5	Frame with 3.5" ADA Bottom Plaque w/ Divider
	FV__1211(V)DWD3.5	Frame with 3.5" Decorative Wood Plaque w/ Divider
	FV__1211(V)DMD3.5	Frame with 3.5" Decorative Metal Plaque w/ Divider
9"h x 6"w (6" x 6")	FV__0906(V)A2.0SL	Frame w/ 2" ADA Bottom Plaque and Slider
12" x 8.5"w (8.5" x 8.5")	FV__1285(V)A2.5SL	Frame w/ 2.5" ADA Bottom Plaque and Slider
15" x 8.5"w (11" x 8.5"w)	FV__1585(V)A3.0SL	Frame with 3" ADA Bottom Plaque and Slider

\* All dimensions are nominal display sizes.

**Projection Wall Mount**

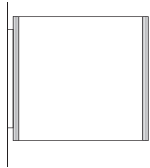

Two FullView modules are attached back-to-back via a unique, high-quality aluminum wall projection extrusion with a square profile. (CMT-M)

Width*	Height	Frame Code	Insert Height	Insert Width
8.5"	8.5"	FV__8585(V)PWM	8.5"	8.5"
8.5"	11"	FV__1185(V)PWM	11"	8.5"
11"	11"	FV__1111(V)PWM	11"	11"
11"	12"	FV__1211(V)PWM	12"	11"
11"	14"	FV__1411(V)PWM	14"	11"
11"	17"	FV__1711(V)PWM	17"	11"

\* All dimensions are nominal display sizes.

**Pin Attachment**

*For Fabric Mounting*

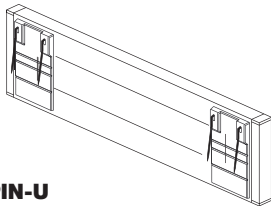

**PIN-U**

A unique dual-pin feature allows smaller FullView frames to attach to fabric surfaces.

Compatible with the following FullView Standard Assembly, Top Access, Inner Access or E-Series frame sizes:

- 3"h x 6"w
- 3"h x 8.5"w
- 4"h x 4"w
- 4"h x 6"w
- 6"h x 4"w

**Panel Clip Attachment**

*For Office Partitions*

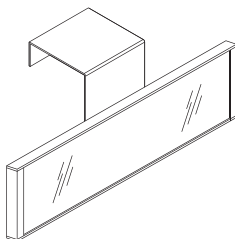

Aluminum clips are custom fabricated to specified dimensions and adhered to the back of the FullView frame.

Compatible with the following FullView Standard Assembly, Top Access, Inner Access or E-Series frame sizes:

- 3"h x 6"w
- 3"h x 8.5"w
- 4"h x 4"w
- 4"h x 6"w
- 4"h x 8.5"w
- 6"h x 4"w
- 6"h x 6"w

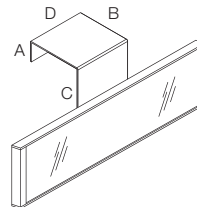

Dimension	Min.	Max.
A	1/2"	1"
B	1"	3"
C (Visible)	0"	3"
D	2"	4"

**Wall Mount**



The Standard Assembly Horizontal Configuration features the aluminum edge profiles at the top/bottom of the sign frame. Inserts are removed from the frame using a lift/pull technique with a Suction Cup Tool.

The Standard Assembly Security Pin Feature is optional with the Horizontal Configuration. If specified, it will be located in the top-left corner of the frame.

**Installation/Mounting**

Standard mounting is via vinyl tape (VT). Mechanical fastening via concealed holes within the frame's core is optional for small sizes and standard for large sizes as indicated by an "MF" suffix in the product code.

**Standard Display Options**

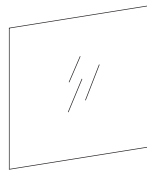

**ClearLens (FVCL)**  
1/8" Non-Glare Acrylic with Subsurface Digitally Printed Graphics

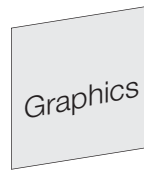

**Painted Plaque (FVOP)**  
1/8" Acrylic with Direct-Print Graphics

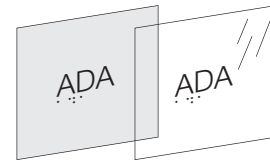

**ADA Plaque (FV341A-DPT)**  
1/8" Acrylic Plaque with UF-Cured, Direct-Print Raised Characters and Fully Domed Braille



**User Lettering Solutions Make Sign Maintenance Easy!**

With APCO's FREE SignWord Pro software, enter your sign message and symbols using pre-established formats or your own custom layouts. Print the image on pre-colored SignWord paper or your own paper and the sign update is complete.

Height *	Width *	Frame Code	Insert Height	Insert Width
4"	4"	FV__0404(H)	4.08"	4.08"
4"	6"	FV__0406(H)	4.08"	6"
4"	8"	FV__0408(H)	4.08"	8"
4"	12"	FV__0412(H)	4.08"	12"
4"	18"	FV__0418(H)	4.08"	18"
6"	6"	FV__0606(H)	6"	6"
6"	8"	FV__0608(H)	6"	8"
6"	12"	FV__0612(H)	6"	12"
6"	18"	FV__0618(H)	6"	18"
6"	24"	FV__0624(H)	6"	24"
8"	24"	FV__0824(H)	8"	24"
8"	36"	FV__0836(H)	8"	36"
8"	48"	FV__0848(H)	8"	48"
8.5"	11"	FV__8511(H)	8.5"	11"
8.5"	14"	FV__8514(H)	8.5"	14"
11"	8.5"	FV__1185(H)	11"	8.5"
11"	11"	FV__1111(H)	11"	11"
11"	17"	FV__1117(H)	11"	17"
12"	24"	FV__1224(H)MF	12"	24"
12"	36"	FV__1236(H)MF	12"	36"
12"	48"	FV__1248(H)MF	12"	48"
18"	24"	FV__1824(H)MF	18"	24"
18"	36"	FV__1836(H)MF	18"	36"
18"	48"	FV__1848(H)MF	18"	48"

\* All dimensions are nominal display sizes.

# Standard Assembly Horizontal Configuration

### Ceiling Mount

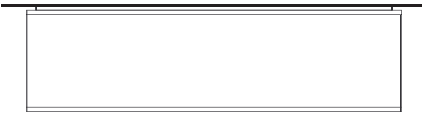

**Flush Mount (CMF)**

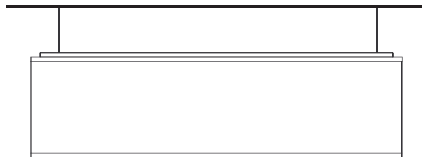

**Wire Suspended (CMW)**

Two FullView modules are attached back-to-back via a unique extruded aluminum mounting bracket with a square profile. CMT-M

### Standard Display Options

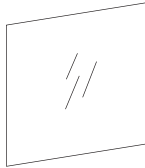

**ClearLens (FVCL)**  
1/8" Non-Glare Acrylic with Subsurface Digitally Printed Graphics

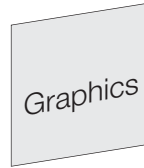

**Painted Plaque (FVOP)**  
1/8" Acrylic with Direct-Print Graphics

Height *	Width *	Frame Code	Description
8"	24"	FV__0824(H)CMF	Flush Mount
		FV__0824(H)CMW	Wire Suspended
8"	36"	FV__0836(H)CMF	Flush Mount
		FV__0836(H)CMW	Wire Suspended
8"	48"	FV__0848(H)CMF	Flush Mount
		FV__0848(H)CMW	Wire Suspended
12"	24"	FV__1224(H)CMF	Flush Mount
		FV__1224(H)CMW	Wire Suspended
12"	36"	FV__1236(H)CMF	Flush Mount
		FV__1236(H)CMW	Wire Suspended
12"	48"	FV__1248(H)CMF	Flush Mount
		FV__1248(H)CMW	Wire Suspended
18"	24"	FV__1824(H)CMF	Flush Mount
		FV__1824(H)CMW	Wire Suspended
18"	36"	FV__1836(H)CMF	Flush Mount
		FV__1836(H)CMW	Wire Suspended
18"	48"	FV__1848(H)CMF	Flush Mount
		FV__1848(H)CMW	Wire Suspended

\* All dimensions are nominal display sizes.

### Inner & Top Access

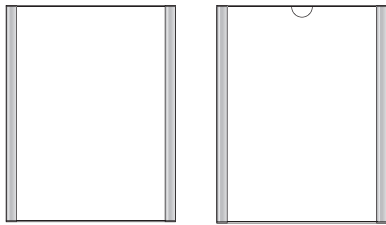

#### Inner Access (FV-IA)

Above Left

Inserts are removed from the top of the frame by using a sticky note or similar. The ClearLens is not removed from the frame.

#### Top Access (FV-TA)

Above Right

Inserts are removed from the top of the frame by using the thumb slot for quick access. The ClearLens is not removed from the frame.

### Standard Display Options

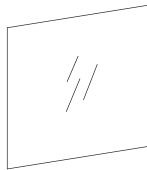

#### ClearLens

(FVCL-IA or FVCL-TA)  
1/16" Non-Glare Acrylic with Subsurface Digitally Printed Graphics

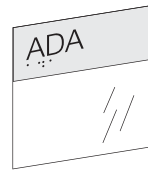

#### ADA Band

(FVADA-DPT)

Flatbed Direct-Print or Painted Band\* with APCO's DP-Tactile process Direct-Print UV-cured raised characters or Braille applied to non-glare, acrylic lens.

\* For non-metallic colors, band is printed directly onto non-glare lens. For metallic colors, a painted band is applied to a non-glare lens.



### User Lettering Solutions Make Sign Maintenance Easy!

With APCO's FREE SignWord Pro software, enter your sign message and symbols using pre-established formats or your own custom layouts. Print the image on pre-colored SignWord paper or your own paper and the sign update is complete.

### Installation/Mounting

Top Access and Inner Access modules can only be installed via vinyl tape (VT). *Mechanical fastening is not an option with the Inner Access or Top Access assemblies.*

Width *	Height *	Frame Code	Compatible ADA Bands & Sizes
4"	4"	FV__0404(V)-IA or -TA	FVADA-DPT-0204(V) 2"h x 4"w
4"	6"	FV__0604(V)-IA or -TA	
4"	8"	FV__0804(V)-IA or -TA	
6"	3"	FV__0306(V)-IA or -TA	FVADA-DPT-0206(V) 2"h x 6"w
6"	4"	FV__0406(V)-IA or -TA	FVADA-DPT-2506(V) 2.5"h x 6"w
6"	6"	FV__0606(V)-IA or -TA	FVADA-DPT-0306(V) 3"h x 6"w
6" <sup>1</sup>	7" <sup>1</sup>	FV__0706(V)SL-IA or -TA w/ Slider <sup>1</sup>	
6"	8"	FV__0806(V)-IA or -TA	
8.5"	3"	FV__0385(V)-IA or -TA	FVADA-DPT-2585(V) 2.5"hx8.5"w
8.5"	4"	FV__0485(V)-IA or -TA	FVADA-DPT-0385(V) 3"h x 8.5"w
8.5"	5.5"	FV__5585(V)-IA or -TA	
8.5"	6.5"	FV__6585(V)-IA or -TA	
8.5"	8.5"	FV__8585(V)-IA or -TA	
8.5" <sup>2</sup>	9.6" <sup>2</sup>	FV__9685(V)SL-IA or -TA w/ Slider <sup>2</sup>	
8.5"	11"	FV__1185(V)-IA or -TA	
8.5"	14"	FV__1485(V)-IA or -TA	
11"	8.5"	FV__8511(V)-IA or -TA	FVADA-DPT-2511(V) 2.5"hx11"w
11"	11"	FV__1111(V)-IA or -TA	FVADA-DPT-0311(V) 3"h x 11"w
11"	12"	FV__1211(V)-IA or -TA	FVADA-DPT-3511(V) 3.5"hx11"w
11"	17"	FV__1711(V)-IA or -TA	

\* All dimensions are nominal display sizes.

<sup>1</sup> Modular display sizes is 6" x 6"

<sup>2</sup> Modular display size is 8.5" x 8.5"

# Inner Access & Top Access Assemblies Vertical Configuration



## Inner & Top Access With ADA or Decorative Bottom Plaque

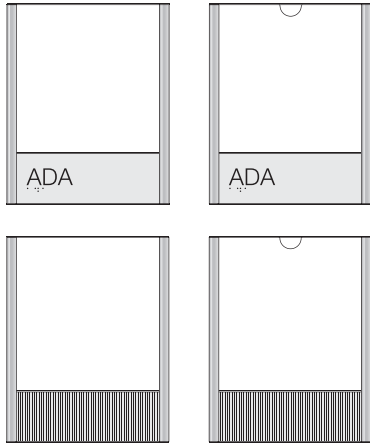

**Inner Access (FV-IA) Above Left**  
Inserts are removed from the top of the frame by using a sticky note or similar. The ClearLens is not removed from the frame.

**Top Access (FV-TA) Above Right**  
Inserts are removed from the top of the frame by using the thumb slot for quick access. The ClearLens is not removed from the frame.

## Standard Display Options



**ADA Bottom Plaque**  
(FV341A-DPT) without Divider  
(FV241A-DPT) with Divider  
1/8" or 1/16" Plaque with  
Direct-Printed Raised  
Character/Braille, Permanently  
Attached to Frame

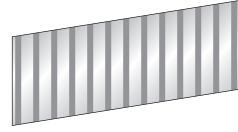

**Decorative Metal Plaque**  
(FVDM\_\_\_)  
DMP3 MicroPerf  
DMS4 Dimpled

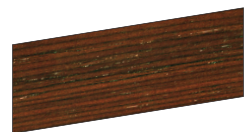

**Direct-Printed  
Decorative Wood Plaque**  
(FVDW\_\_\_)  
DWM1 Maple  
DWW2 Walnut  
DWO3 Oak  
DWC4 Cherry  
DWM5 Mahogany

## Frame Size

(Top Display)	Frame Code	Description
6"h x 4"w (4.08" x 4.08")	FV__0604(V)A2.0-IA or -TA	with 2" ADA Bottom Plaque
	FV__0604(V)AD2.0-IA or -TA	with 2" ADA Bottom Plaque w/ Divider
	FV__0604(V)DWD2.0-IA or -TA	with 2" Decorative Wood Plaque+Divider
6"h x 6"w (4" x 6")	FV__0604(V)DMD2.0-IA or -TA	with 2" Decorative Metal Plaque+Divider
	FV__0606(V)A2.0-IA or -TA	with 2" ADA Bottom Plaque
	FV__0606(V)AD2.0-IA or -TA	with 2" ADA Bottom Plaque+Divider
8"h x 6"w (6" x 6")	FV__0606(V)DWD2.0-IA or -TA	with 2" Decorative Wood Plaque+Divider
	FV__0606(V)DMD2.0-IA or -TA	with 2" Decorative Metal Plaque+Divider
	FV__0806(V)A2.0-IA or -TA	with 2" ADA Bottom Plaque
6.5"h x 8.5"w (3" x 8.5")	FV__0806(V)AD2.0-IA or -TA	with 2" ADA Bottom Plaque+Divider
	FV__0806(V)DWD2.0-IA or -TA	with 2" Decorative Wood Plaque+Divider
	FV__0806(V)DMD2.0-IA or -TA	with 2" Decorative Metal Plaque+Divider
6.5"h x 8.5"w	FV__5585(V)A2.5-IA or -TA	with 2.5" ADA Bottom Plaque
	FV__5585(V)AD2.5-IA or -TA	with 2.5" ADA Bottom Plaque+Divider
	FV__5585(V)DWD2.5-IA or -TA	with 2.5" Decorative Wood Plaque+Divider
6.5"h x 8.5"w	FV__5585(V)DMD2.5-IA or -TA	with 2.5" Decorative Metal Plaque+Divider
	FV__6585(V)A2.5-IA or -TA	with 2.5" ADA Bottom Plaque
	FV__6585(V)AD2.5-IA or -TA	with 2.5" ADA Bottom Plaque+Divider
11"h x 8.5"w (8.5" x 8.5")	FV__6585(V)DWD2.5-IA or -TA	with 2.5" Decorative Wood Plaque+Divider
	FV__6585(V)DMD2.5-IA or -TA	with 2.5" Decorative Metal Plaque+Divider
	FV__1185(V)A2.5-IA or -TA	with 2.5" ADA Bottom Plaque
14"h x 8.5"w (11" x 8.5")	FV__1185(V)AD2.5-IA or -TA	with 2.5" ADA Bottom Plaque+Divider
	FV__1185(V)DWD2.5-IA or -TA	with 2.5" Decorative Wood Plaque+Divider
	FV__1185(V)DMD2.5-IA or -TA	with 2.5" Decorative Metal Plaque+Divider
12"h x 11"w (8.5" x 11")	FV__1485(V)A3.0-IA or -TA	with 3" ADA Bottom Plaque
	FV__1485(V)AD3.0-IA or -TA	with 3" ADA Bottom Plaque+Divider
	FV__1485(V)DWD3.0-IA or -TA	with 3" Decorative Wood Plaque+Divider
12"h x 11"w (8.5" x 11")	FV__1485(V)DMD3.0-IA or -TA	with 3" Decorative Metal Plaque+Divider
	FV__1211(V)A3.5-IA or -TA	with 3.5" ADA Bottom Plaque
	FV__1211(V)AD3.5-IA or -TA	with 3.5" ADA Bottom Plaque+Divider
9"h x 6"w (6" x 6")	FV__1211(V)DWD3.5-IA or -TA	with 3.5" Decorative Wood Plaque+Divider
	FV__1211(V)DMD3.5-IA or -TA	with 3.5" Decorative Metal Plaque+Divider
	FV__0906(V)A2.0SL-IA or -TA	with 2" ADA Bottom Plaque+Slider
12"h x 8.5"w (8.5" x 8.5")	FV__1285(V)A2.5SL-IA or -TA	with 2.5" ADA Bottom Plaque+Slider
15"h x 8.5"w (11" x 8.5"w)	FV__1585(V)A3.0SL-IA or -TA	with 3" ADA Bottom Plaque+Slider

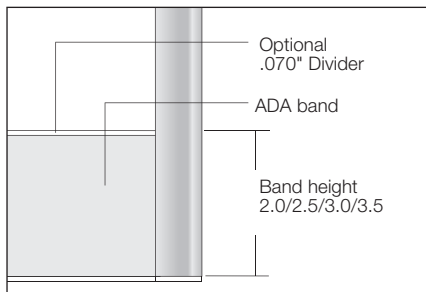

## ADA Plaque Divider

A .070" anodized aluminum Divider Bar is an optional feature to separate the ADA plaque from the top display.

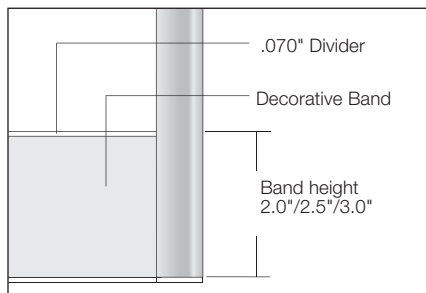

## Decorative Plaque Divider

All Decorative Plaques feature a .070" anodized aluminum Divider Bar.

**Wall Mount**

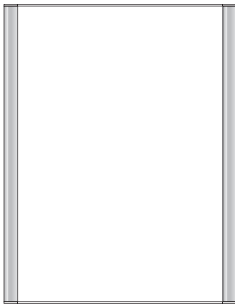

The FullView E-Series features the same aluminum frames and profiles as the Standard Assembly but uses 1/16" thick flexible inserts (vs. the 1/8" thick rigid inserts of the Standard Assembly) which flex-in and flex-out of the frame via a Suction Cup Tool. E-Series frames do not incorporate a concealed security pin but offer a high degree of tamper resistance nonetheless.

**Installation/Mounting**

Standard mounting is via vinyl tape (VT). Mechanical fastening (MF) via concealed holes within the frame's core is optional.

**FullView E-Series with Square Shape Edge Profile**

Features a single piece aluminum cap at the top and bottom of the frame.

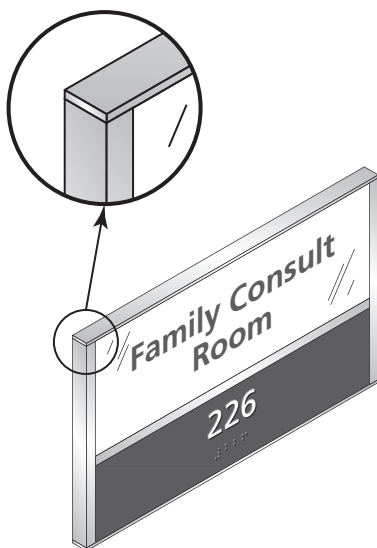

**Standard Display Options**

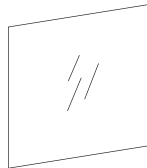

**ClearLens**  
(FVECL)  
1/16" Non-Glare Acrylic with Subsurface Digitally Printed Graphics

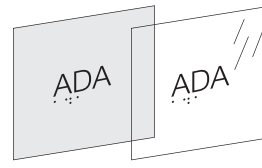

**ADA Plaque**  
(FV241A-DPT)  
1/16" Acrylic Plaque with UF-Cured, Direct-Print Raised Characters and Fully Domed Braille

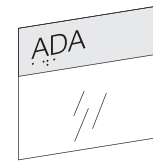

**ADA Band**  
(FVADA-DPT)  
Flatbed Direct-Print or Painted Band\* with APCO's DP-Tactile process Direct-Print UV-cured raised characters or Braille applied to non-glare, acrylic lens.

\* For non-metallic colors, band is printed directly onto non-glare lens. For metallic colors, a painted band is applied to a non-glare lens.

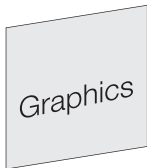

**Painted Plaque**  
(FVEOP)  
1/16" PETG with Direct-Printed Graphics



**User Lettering Solutions Make Sign Maintenance Easy!**

With APCO's FREE SignWord Pro software, enter your sign message and symbols using pre-established formats or your own custom layouts. Print the image on pre-colored SignWord paper or your own paper and the sign update is complete.

Width *	Height *	Frame Code	Compatible ADA Bands
4"²	4"²	FVE_0404(V)	FVADA-DPT-0204(V) 2"h x 4"w
4"²	6"	FVE_0604(V)	
4"²	8"	FVE_0804(V)	
6"	3"	FVE_0306(V)	FVADA-DPT-0206(V) 2"h x 6"w
6"	4"	FVE_0406(V)	FVADA-DPT-2506(V) 2.5"h x 6"w
6"	6"	FVE_0606(V)	
6"	8"	FVE_0806(V)	
6"	10"	FVE_1006(V)	
8.5"	3"	FVE_0385(V)	FVADA-DPT-2585(V) 2.5"h x 8.5"w
8.5"	4"	FVE_0485(V)	FVADA-DPT-0385(V) 3"h x 8.5"w
8.5"	5"	FVE_0585(V)	
8.5"	5.5"	FVE_5585(V)	
8.5"	6.5"	FVE_6585(V)	
8.5"	8.5"	FVE_8585(V)	
8.5"¹	9.6"¹	FVE_9685(V)SL w/ Slider¹	
8.5"	11"	FVE_1185(V)	
8.5"	14"	FVE_1485(V)	
11"	8.5"	FVE_8511(V)	FVADA-DPT-2511(V) 2.5"h x 11"w
11"	11"	FVE_1111(V)	FVADA-DPT-0311(V) 3"h x 11"w
11"	12"	FVE_1211(V)	FVADA-DPT-3511(V) 3.5"h x 11"w
11"	14"	FVE_1411(V)	
11"	17"	FVE_1711(V)	

\* All dimensions are nominal display sizes.

¹ Modular display sizes is 6" x 6"

² Actual dimension is 4.08"

**Wall Mount**

With Divider Bar & ADA Plaque

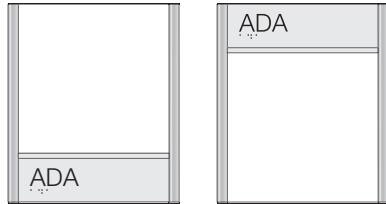

The FullView E-Series with Top or Bottom ADA Plaques features a removable ADA plaque separated from the display insert by a permanently affixed 1/4" aluminum divider bar (FVDB).

**Standard Display Options**

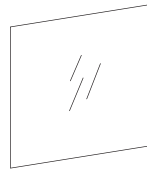

**ClearLens**  
(FVECL)  
1/16" Non-Glare Acrylic with Subsurface Digitally Printed Graphics

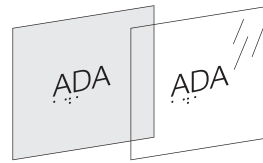

**ADA Plaque**  
(FV241A-DPT)  
1/16" Acrylic Plaque with UF-Cured, Direct-Print Raised Characters and Fully Domed Braille

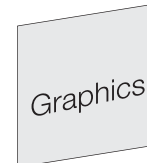

**Painted Plaque**  
(FVEOP)  
1/16" Acrylic with Direct-Printed Graphics



Perforated SignWord Paper Available for These Sizes.

**ADA TOP Plaque Modules**

Width	Height	Frame Code	Description
6"	5.75"	FVE__57506(V)ATD2.5	with 2.5" ADA Plaque at Top and a 3"h x 6"w Display at Bottom
6"	6.75"	FVE__67506(V)ATD2.5	with 2.5" ADA Plaque at Top and a 4"h x 8.5"w Display at Bottom
8.5"	5.75"	FVE__57585(V)ATD2.5	with 2.5" ADA Plaque at Top and a 3"h x 8.5"w Display at Bottom
8.5"	6.75"	FVE__67585(V)ATD2.5	with 2.5" ADA Plaque at Top and a 4"h x 8.5"w Display at Bottom
8.5"	8.75"	FVE__87585(V)ATD2.5	with 2.5" ADA Plaque at Top and a 6"h x 8.5"w Display at Bottom
8.5"	11.75"	FVE__117585(V)ATD3.0	with 3" ADA Plaque at Top and a 8.5"h x 8.5"w Display at Bottom

**ADA BOTTOM Plaque Modules**

Width	Height	Frame Code	Description
6"	5.75"	FVE__57506(V)ABD2.5	with 2.5" ADA Plaque at Bottom and a 3"h x 6"w Display at Top
6"	6.75"	FVE__67506(V)ABD2.5	with 2.5" ADA Plaque at Bottom and a 4"h x 6"w Display at Top
8.5"	5.75"	FVE__57585(V)ABD2.5	with 2.5" ADA Plaque at Bottom and a 3"h x 8.5"w Display at Top
8.5"	6.75"	FVE__67585(V)ABD2.5	with 2.5" ADA Plaque at Bottom and a 4"h x 8.5"w Display at Top
8.5"	8.75"	FVE__87585(V)ABD2.5	with 2.5" ADA Plaque at Bottom and a 6"h x 8.5"w Display at Top
8.5"	11.75"	FVE__117585(V)ABD3.0	with 3" ADA Plaque at Bottom and a 8.5"h x 8.5"w Display at Top

**Single & Multi Column**

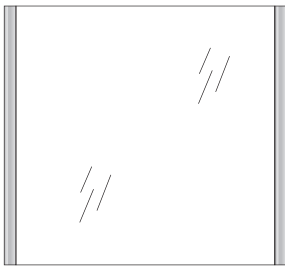

The Large Assembly Vertical Configuration Frame FVL(V) features concealed spring mechanisms within the right side aluminum profile which enable the 1/8" non-glare lens to be removed from the frame using a Large Suction Cup Tool and a shift-right/pull-out technique.

**Standard Display Options**

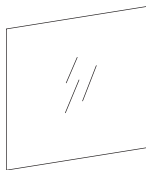

**ClearLens**  
(FVLCL)  
1/8" Non-Glare Acrylic with Subsurface Digitally Printed Graphics

**Frame Profile**

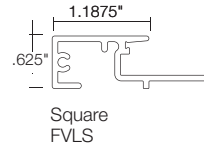

**Single Column**

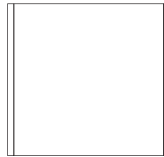

Width *	Height *	Frame Code
22"	22"	FVL_2222(V)
22"	28"	FVL_2822(V)
24"	24"	FVL_2424(V)
24"	28"	FVL_2824(V)
24"	32"	FVL_3224(V)
24"	36"	FVL_3624(V)

\* All dimensions are nominal display sizes.

**Multi Column**

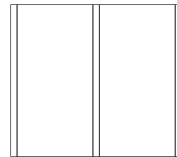

**FVL\_-24MC1(V)**  
24"h x 25"w (Nominal)  
(2) 24"h x 12"w Display Size

**FVL\_-36MC1(V)**  
36"hx 25"w (Nominal)  
(2) 36"h x 12"w Display Size

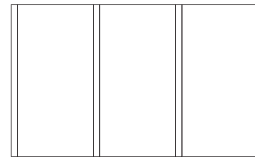

**FVL\_-24MC2(V)**  
24"h x 38"w (Nominal)  
(3) 24"h x 12"w Display Size

**FVL\_-36MC2(V)**  
36"hx 38"w (Nominal)  
(3) 36"h x 12"w Display Size



**FVL\_-24MC3(V)**  
24"h x 37"w (Nominal)  
(1) 24"h x 12"w &  
(1) 24"h x 24"w Display Size

**FVL\_-36MC3(V)**  
36"hx 37"w (Nominal)  
(1) 36"h x 12"w &  
(1) 36"h x 24"w Display Size

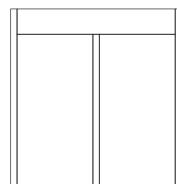

**FVL\_-28MCH1(V)**  
28-1/16"h x 25"w (Nominal)  
(2) 24"h x 12" Display Size  
(1) 4" h x 25"w Header

**FVL\_-36MC1(V)**  
40-1/16"h x 25"w (Nominal)  
(2) 36"h x 12" Display Size  
(1) 4" h x 25"w Header

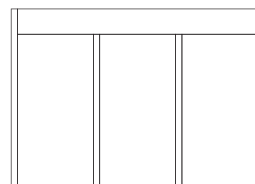

**FVL\_-28MCH2(V)**  
28-1/16"h x 38"w (Nominal)  
(3) 24"h x 12" Display Size  
(1) 4" h x 38"w Header

**FVL\_-40MCH1(V)**  
40-1/16"h x 38"w (Nominal)  
(3) 36"h x 12" Display Size  
(1) 4" h x 38"w Header

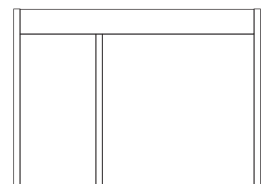

**FVL\_-28MCH3(V)**  
28-1/16"h x 37"w (Nominal)  
(1) 24"h x 12" &  
(1) 24"h x 24"w Display Size  
(1) 4" h x 37"w Header

**FVL\_-40MCH1(V)**  
40-1/16"h x 37"w (Nominal)  
(1) 36"h x 12" &  
(1) 36"h x 24"w Display Area  
(1) 4" h x 37"w Size

**INSTALLATION NOTE**

ALL FullView Large Assembly modules feature concealed recessed mounting holes for mechanical fastening (MF) to the wall surface. **Vinyl Tape mounting is not recommended.**

**Single Column**

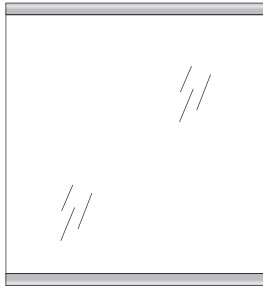

The Large Assembly Horizontal Configuration Frame FVL(H) features the aluminum edge profiles on the Top/Bottom of the frame and an 1/8" thick non-glare lens that is removed from the frame using a Large Suction Cup Tool and a Lift/Pull technique.

Frames larger than 24"h x 48"w will feature a side locking extrusion (4-Side Capture) on both the left and right sides of the frame as shown in the images below. This feature is optional for smaller sizes as well for additional tamper resistance.

**4-Side Locking Feature Capture**

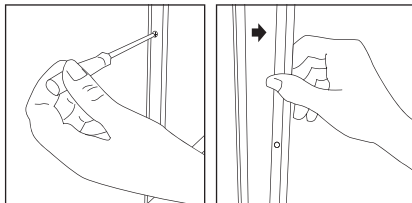

4-Side Capture extrusion is removed from the frame using a Phillips screwdriver.

Once both capture extrusions are removed, the non-glare lens can be shifted up and the pulled outward from the frame using a Large Suction Cup Tool.

**Standard Display Options**

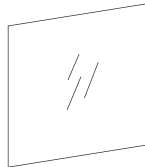

**ClearLens**

(FVLCL)  
1/8" Non-Glare Acrylic  
with Subsurface Digitally  
Printed Graphics

**Frame Profile**

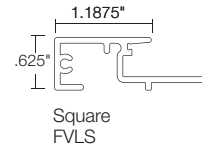

Height *	Width *	Frame Code
22"	22"	FVL_2222(H)
	28"	FVL_2228(H)
	36"	FVL_2236(H)
24"	24"	FVL_2424(H)
	36"	FVL_2436(H)
	48"	FVL_2448(H)
36"	36"	FVL_3636(H)4C with 4-Side Capture Feature
	42"	FVL_3642(H)4C with 4-Side Capture Feature
	48"	FVL_3648(H)4C with 4-Side Capture Feature
	54"	FVL_3654(H)4C with 4-Side Capture Feature
	60"	FVL_3660(H)4C with 4-Side Capture Feature

\* All dimensions are nominal display sizes.

**INSTALLATION NOTE**  
ALL FullView Large Assembly modules feature concealed recessed mounting holes for mechanical fastening (MF) to the wall surface. Vinyl Tape mounting is not recommended.

### FS300 Series

Free Standing Pedestal

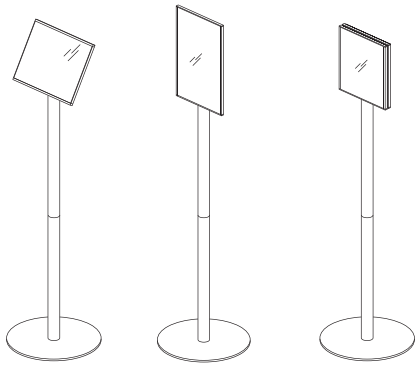

**FS300**  
Incline  
Single-sided

**FS301**  
Vertical  
Single-sided

**FS301.2**  
Vertical  
Double-sided

Signs are easily affixed to a two-piece 42" aluminum post via a modular steel mounting plate. A 1/4" steel base plate acts as a counter weight at the bottom of the post. The FS300 Series accepts both Vertical (portrait) and Horizontal (landscape) display configurations.

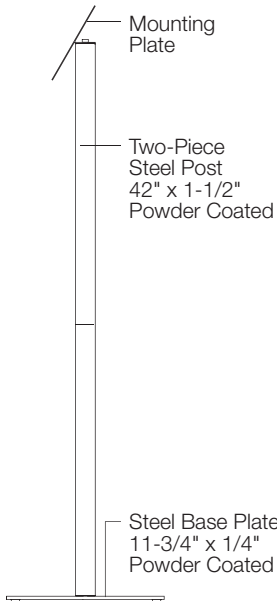

#### Standard Post Finishes

- Natural Satin Anodized (recommended)
- Painted: (not recommended)  
Standard (44+)  
Custom

#### Standard Base Plate Finishes

- Powder Coated  
Silver (recommended)
- Painted (not recommended)  
Standard (44+)  
Custom

#### Compatible FullView Holders\*

Code	Insert Size
<b>FV1185(V)</b>	11" x 8.5"
<b>FV8511(H)</b>	8.5" x 11"
<b>FV1485(V)</b>	14" x 8.5"
<b>FV8514(H)</b>	8.5" x 14"
<b>FV1117(V)</b>	11" x 17"
<b>FV1711(H)</b>	17" x 11"

\* Also compatible with Top Access, Inner Access and E Series holders of the same sizes shown here.

#### FS300 Series Mounting Plates

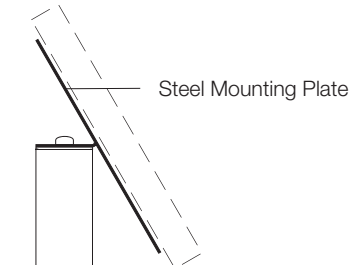

**FS300**  
60 Degree Inclined

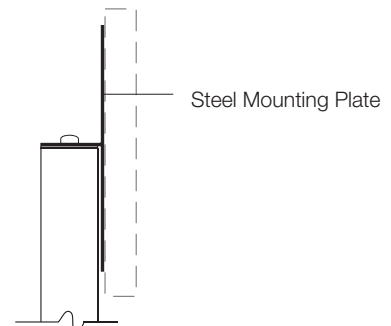

**FS301**  
Vertical Single Sided

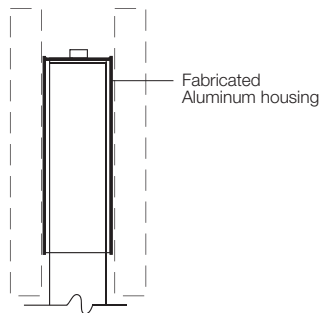

**FS301.2**  
Vertical Double Sided

**Kiosks**

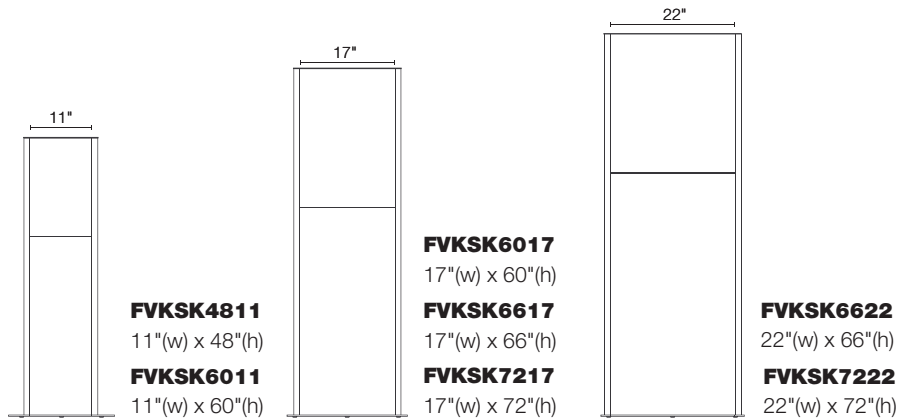
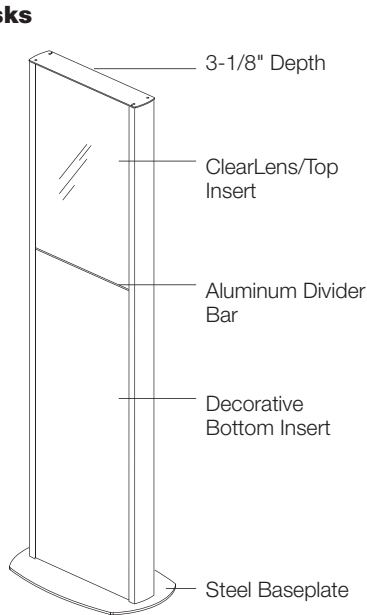

The FullView Kiosk is a versatile free-standing sign & display solution allowing maps, directions, meeting schedule, announcements and other information to be strategically placed within a facility.

Digitally printed displays are housed behind a secure yet modular non-glare lens. Change displays by removing the lens using a Large Suction Cup Tool and a shift-right/pull-out technique. A range of decorative panels and other graphics options are also available.

**Aluminum Divider Bar**

When there are two inserts within the same side of the a FullView Kiosk, there will be a satin anodized aluminum divider bar to separate the top insert from the bottom. This bar prevents the insert from sliding down. The top insert/ClearLens size will be kept to exact dimensions and the aluminum divider bar height will be subtracted from the bottom insert height as needed.

**Direct Print Wood Options**

- DWM1 Maple
- DWW2 Walnut
- DWO3 Oak
- DWC4 Cherry
- DWM5 Mahogany

**Decorative Metal Options**

- DMP5 Ribbed Silver Finish
- DMS4 Dimpled Silver Finish

\* .070" to .25" may be subtracted from bottom insert height to account for optional divider bar

Width	Height	Code	Top Insert Height	Corresponding Bottom Insert Height *			
11"	48"	<b>FVKSK4811</b>	48"	n/a			
			22"	26"			
			17"	31"			
			11"	37"			
			8.5"	39.5"			
11"	60"	<b>FVKSK6011</b>	60"	n/a			
			22"	38"			
			17"	43"			
			11"	49"			
17"	60"	<b>FVKSK6017</b>	60"	n/a			
			36"	24"			
			30"	30"			
			24"	36"			
			22"	38"			
			17"	43"			
			11"	49"			
			17"	66"	<b>FVKSK6617</b>	66"	n/a
						36"	30"
						30"	36"
24"	42"						
22"	44"						
17"	49"						
11"	55"						
17"	72"	<b>FVKSK7217</b>	72"	n/a			
			42"	30"			
			36"	36"			
			30"	42"			
			24"	48"			
			22"	50"			
			17"	55"			
			11"	61"			
			22"	66"	<b>FVKSK6622</b>	66"	n/a
						36"	30"
30"	36"						
24"	42"						
22"	44"						
17"	49"						
22"	72"	<b>FVKSK7222</b>				72"	n/a
						42"	30"
			36"	36"			
			30"	42"			
			24"	48"			
			22"	50"			
			17"	55"			

## SignWord® Paper Inserts

Sold in packages of 50 sheets

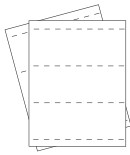

FREE SignWord Pro software download at [www.apcosigns.com](http://www.apcosigns.com).

### Standard Paper Colors

A43 Putty / A94 Sand  
A72 Bone White / A00 White  
A78 Pearl Gray / A98 Pearl Gray Light

Insert Width	Insert Height	Paper/Sheet Code	Inserts Per Sheet	Notes
6"	3"	<b>SWFV3085</b>	3	must be cut to width
	4"	<b>SWFV4085</b>	2	must be cut to width
8-1/2"	3"	<b>SWFV3085</b>	3	
	4"	<b>SWFV4085</b>	2	
	8-1/2"	<b>SWFV8511</b>	1	must be cut to width
	11"	<b>SWFV8511</b>	1	
11"	14"	<b>SWFV8514</b>	1	
	8-1/2"	<b>SWFV8511</b>	1	
	11"	<b>SWFV1117</b>	1	must be cut to height
17"	17"	<b>SWFV1117</b>	1	
	11"	<b>SWFV1117</b>	1	

**NOTE:** Consult APCO for colors and availability of non-SignWord paper, i.e. 8-1/2" x 11", 11" x 17", etc.