

*A Comprehensive
Modular Aluminum
System with a Modern
Frameless Look*



Product Features / Graphic Options	1.8.102
Exploded View Non-Illuminated	1.8.103
Exploded View Illuminated	1.8.104
Panel Removal	1.8.105
Optional Header Shapes	1.8.106
6120 Series Wall Mount Standard Sizes	1.8.107 - 1.8.114
6140 Series Wall Mount Standard Sizes	1.8.115

AluTek is a highly customizable, modular aluminum sign system offering a clean, frameless appearance.

At the core of the system are two unique, proprietary aluminum extrusions that enable AluTek to offer the looks of a custom-fabricated product with all the benefits of a pre-engineered system.

Panels are removable yet held securely in place via concealed fasteners. The system's design also allows for a wide range of panel sizes, materials, sign depths and header shapes.

The precision, computer-driven machining of AluTek combined with APCO's proven craftsmanship ensure a solution that is 100% modular and built to withstand harsh exterior environments.

Features:

- Multiple Graphic Options:
 - Dimensional
 - Pressure Sensitive Vinyl
 - Intaglio
 - Direct-Print
 - Push-Thru
 - Routed & Backed
 - Routed & Flush
- Inbound (Concealed) Post Supports
- Aluminum or Polycarbonate Panels
- Impact Resistant
- Standard/Typical Sign Depths:
 - Pylons (6-1/2")
 - Base Mounts (6-1/2" or 12")
 - Surface Mounts (2", 8" or 12")
- Low-Voltage LED Sign Modules
- UL Listed
- Panels Modulate in 1" Vertical Increments
- Panel Finishes:
 - 2-Part Acrylic Polyurethane
 - Satin Anodized Aluminum
- 5-Year Limited Warranty
- Engineering Services

6120 Series

Ground & Base Mount Configurations

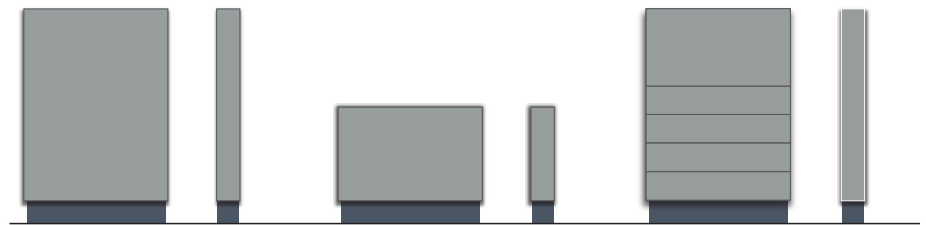

Vertical Monolith or Single-Panel

Horizontal Monolith or Single-Panel

Vertical Multi-Panel

6140 Series

Surface/Wall Mount Configurations



Graphic Options



Non-Illuminated



Dimensional

Intaglio

PSV



Illuminated



Push-Thru

Push-Thru Halo

Routed & Flush

Routed & Backed

**Exploded View
(Non-Illuminated)**

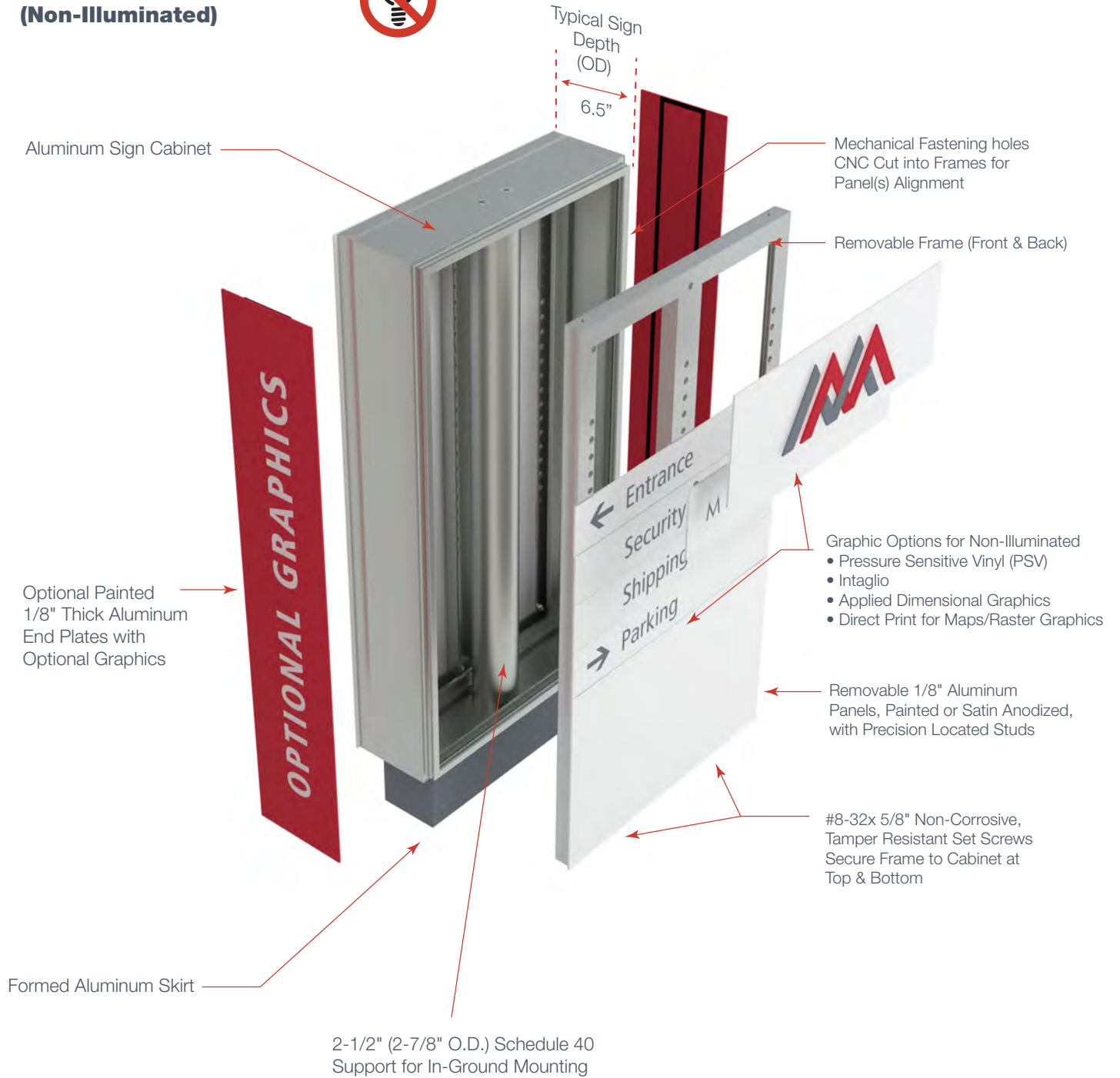

Exploded View (Illuminated) 

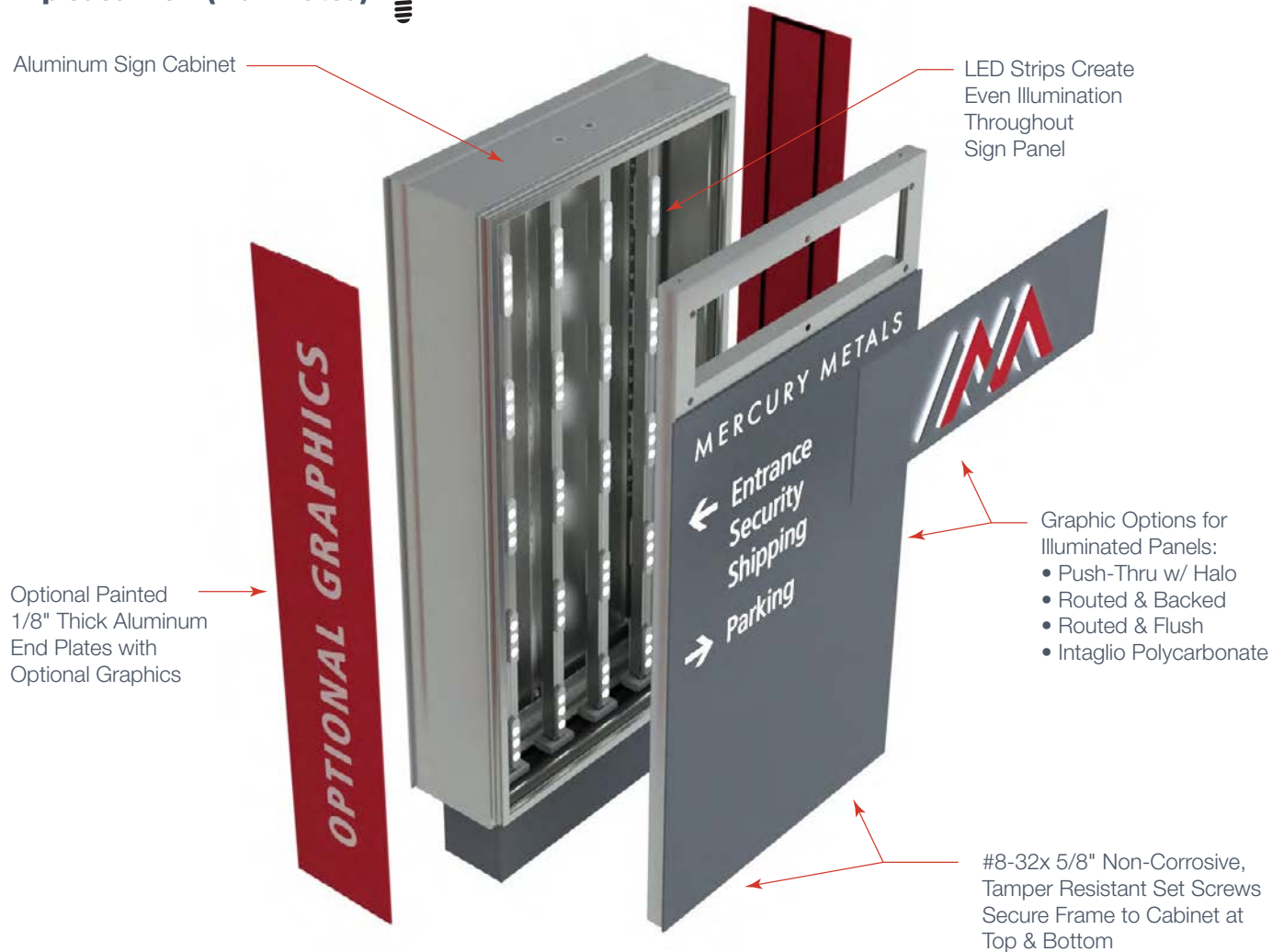

Illuminated Panels (Illumination Area)

Regardless of the height or width of illuminated panels, the panel's internal structure will create a non-illuminated area around the outside perimeter.

Take care to keep all desired illuminated graphics within this area.

6" is the minimum height recommended for illuminated panels.

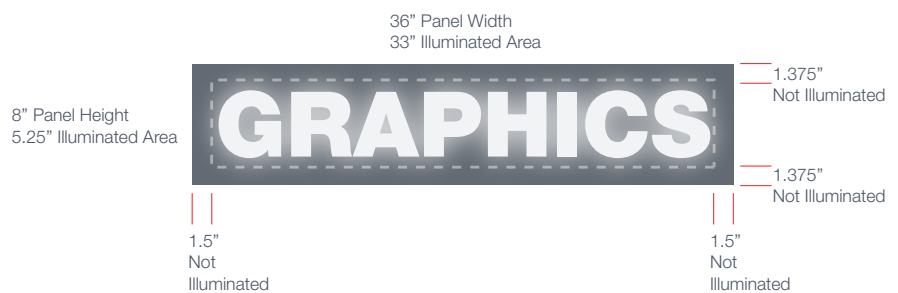

Panel Removal

The unique aluminum extrusions and computer-driven machining of AluTek enable panels to be easily updated in order to accommodate future changes or expansion.

Panels are held securely in place via recessed, tamper-resistant screws. Once removed, frame assemblies can be lifted from the cabinet so that panels can be updated.

The precision engineering of AluTek ensures proper fit and alignment of future replacement panels.



Locate & Remove Recessed, Non-Corrosive, Tamper-Resistant Screws at Top and Bottom of Frame



Remove Frame from Cabinet



Flip Panel over to Remove Panels from Frame by Removing Nuts & Washers from Panel Studs

While modular, AluTek also offers a high degree of design flexibility and opportunities for customization, without the rigid constraints of a traditional framed exterior system.

Custom shapes and/or materials are easily incorporated within an AluTek design, helping to connect with surrounding architectural elements, showcase a brand, or simply to create a unique look.

Optional Header Shapes

Extending Beyond the Top of the Sign Cabinet

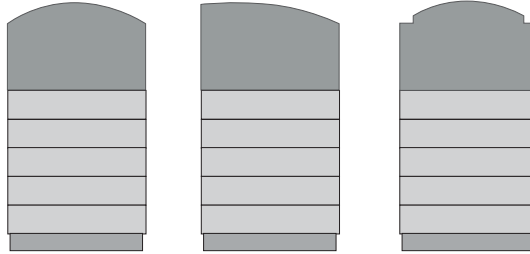

Optional Dimensional Header Shapes

Added to the Face of the Top Headers

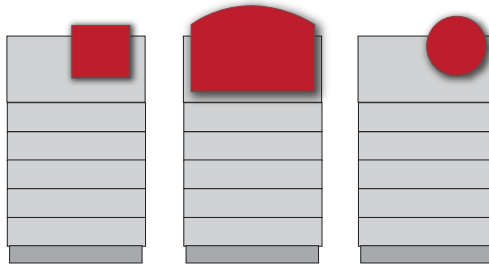

Optional Combination

Extending Beyond the Top of the Sign Cabinet

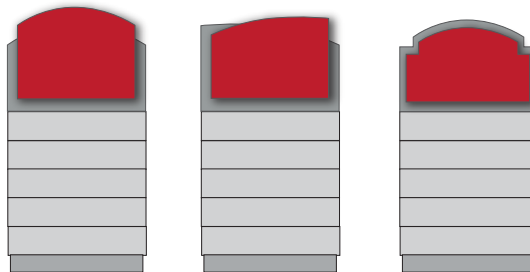

Optional Structural Dimensional Shapes

Added to the Top of the Sign Cabinet

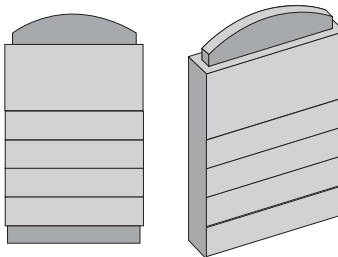

6120 Series

Vertical Configurations



Horizontal Configurations



6120 Series

96" Vertical

Header w/ Bands Configuration

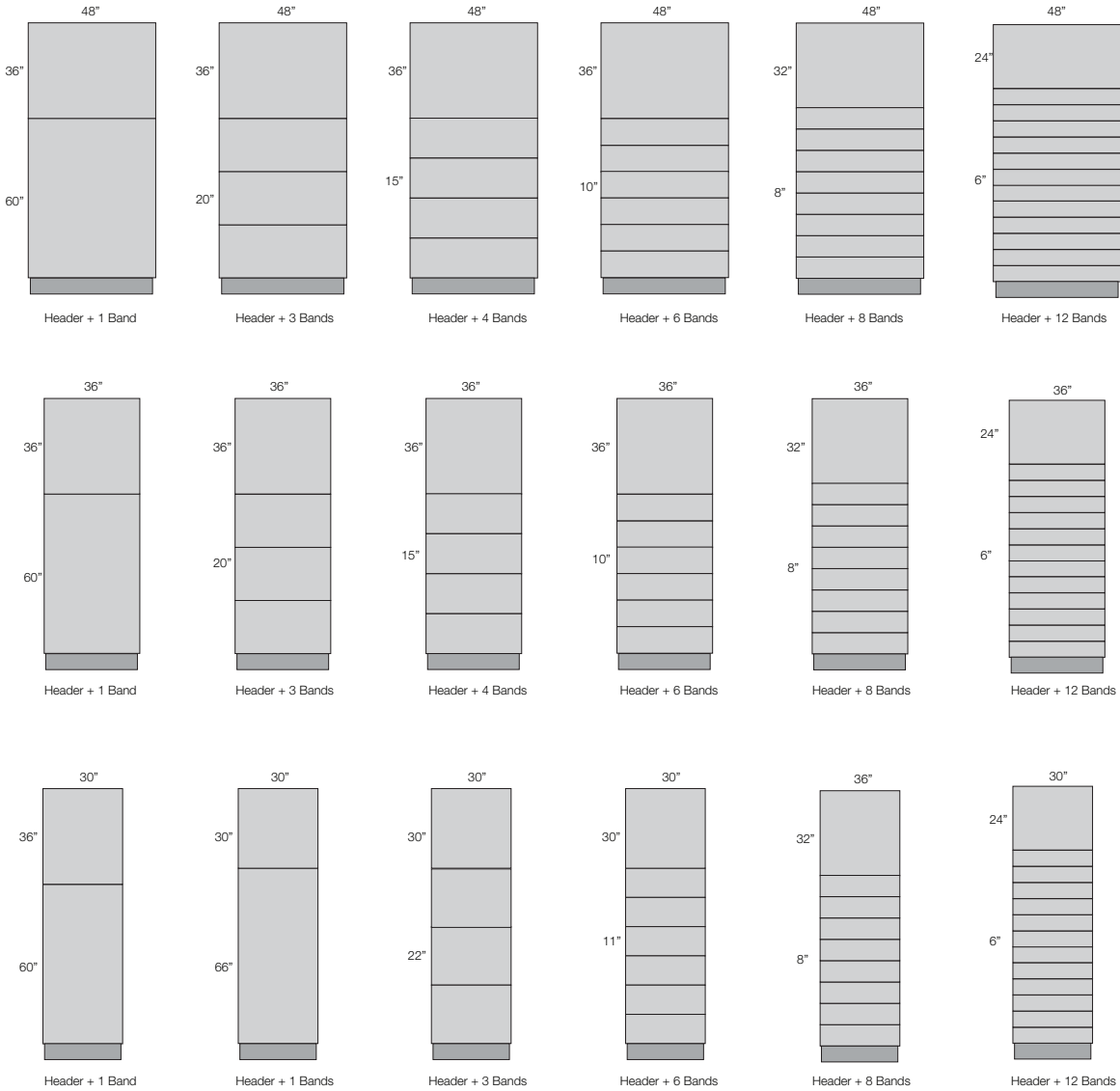

6120 Series

84" Vertical

Header w/ Bands Configuration

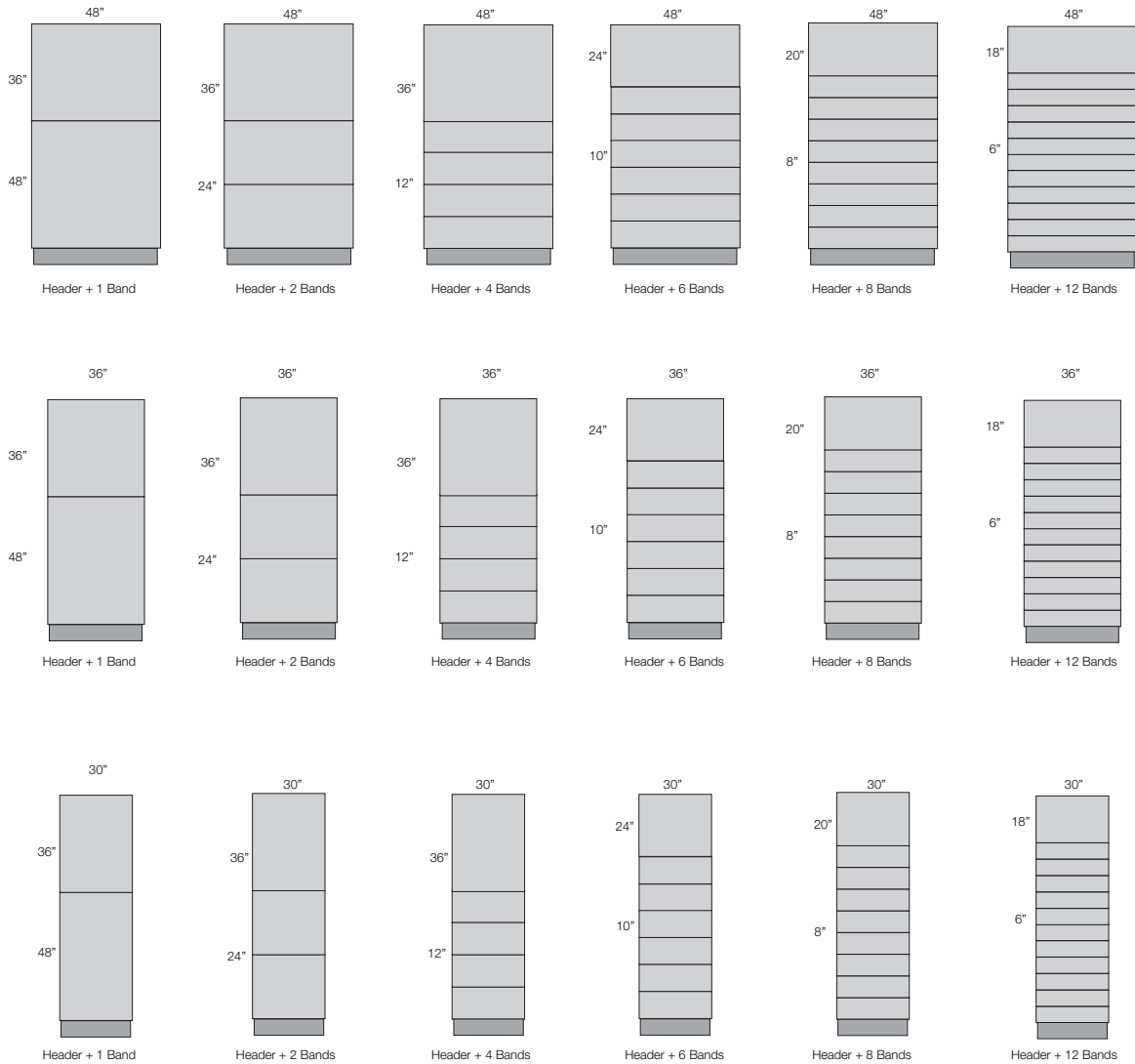

6120 Series

72" Vertical

Header w/ Bands Configuration  

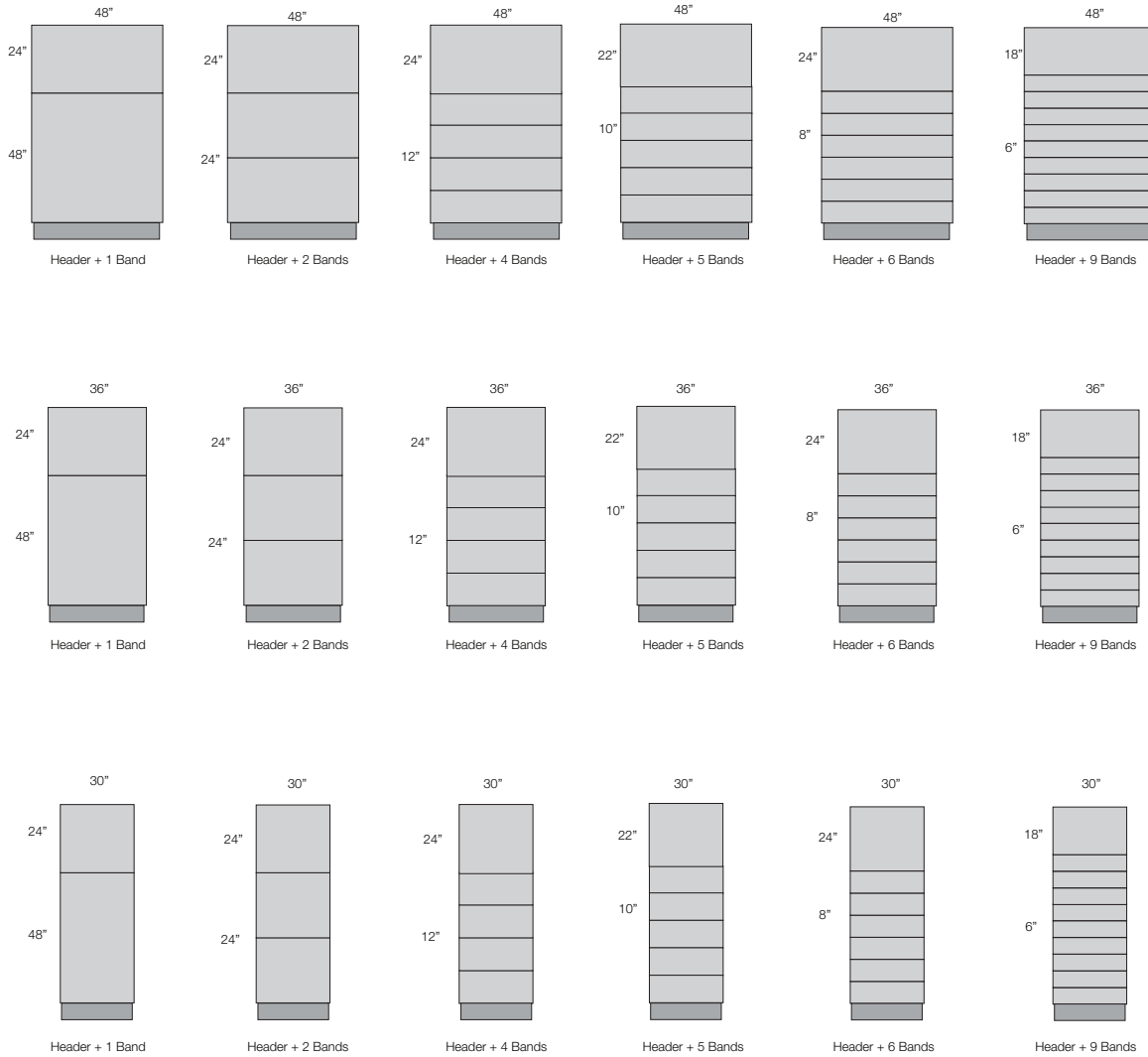

6120 Series

60" Vertical

Header w/ Bands Configuration

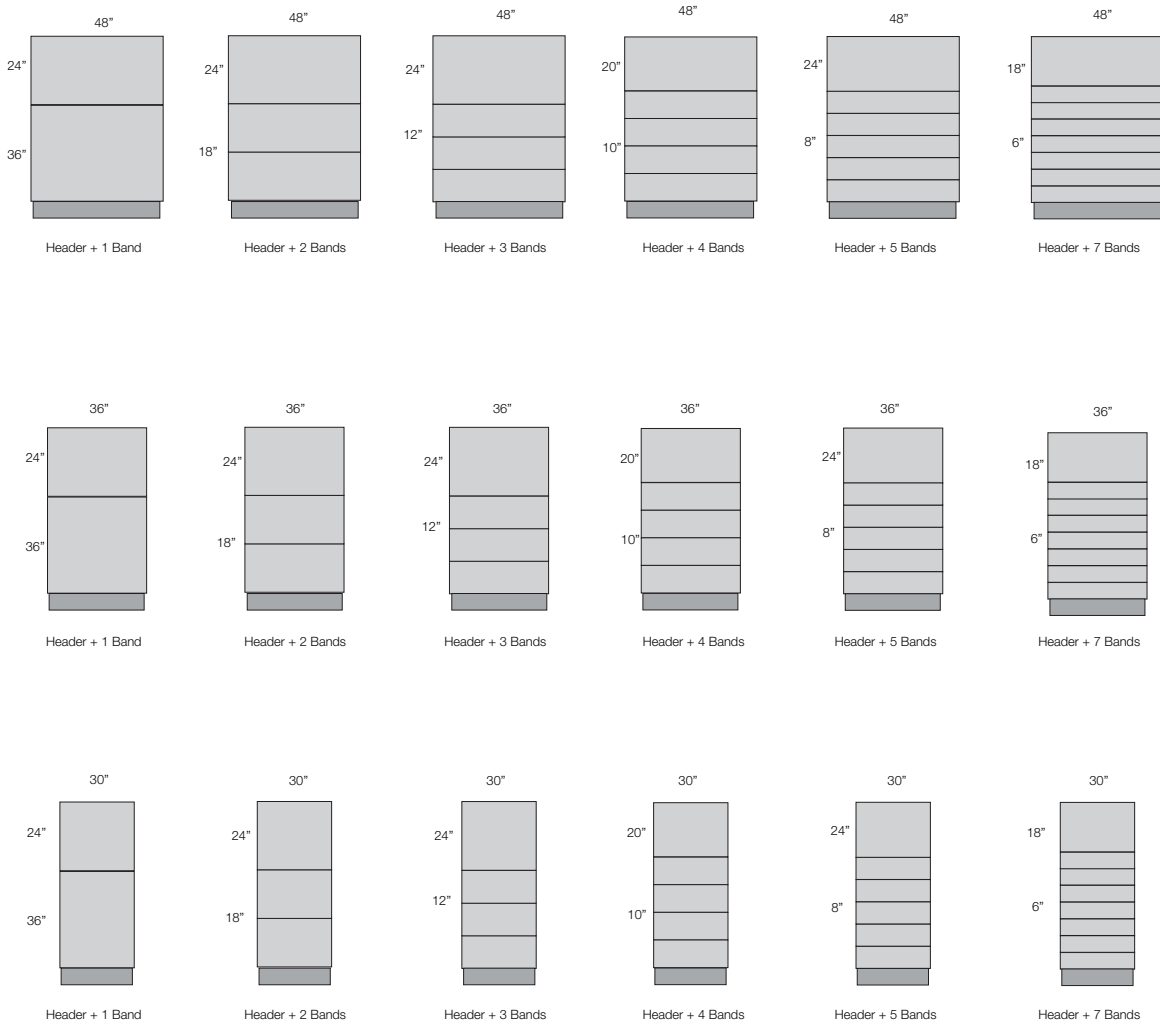

6120 Series

48" Vertical

Header w/ Bands Configuration

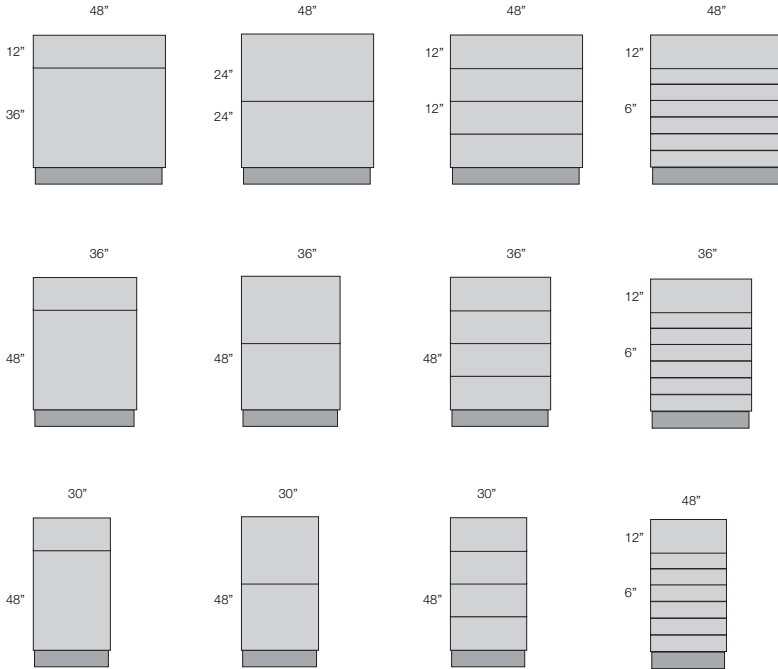

6120 Series

36" Vertical
Header w/ Bands Configuration  

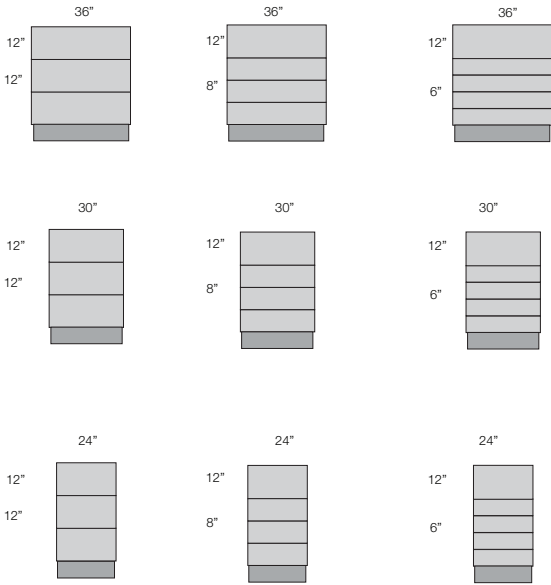

6140 Wall Mount configurations  

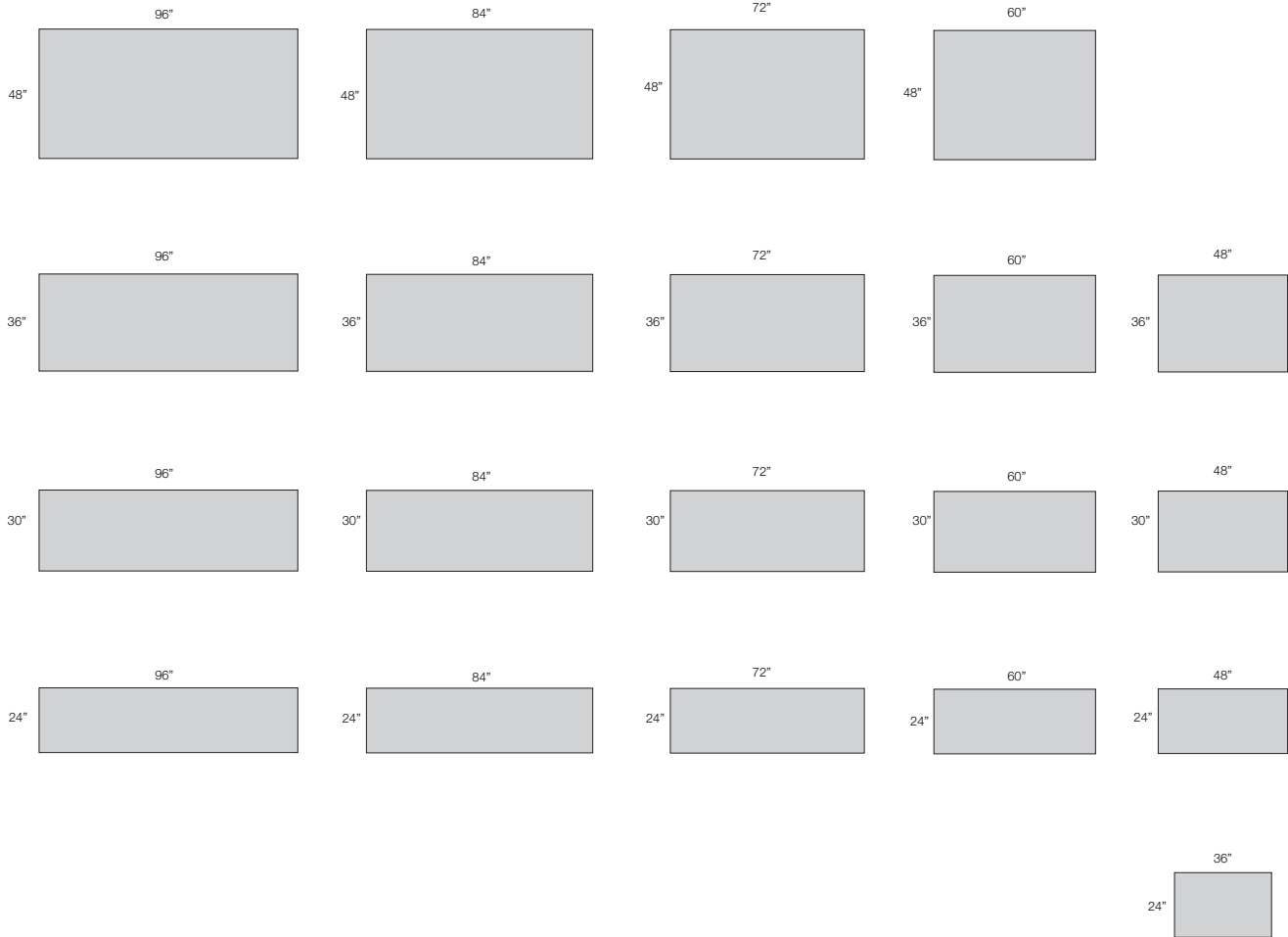

Part of a Complete, Comprehensive Exterior Sign Program

APCO has an extensive range of sign systems and custom-fabricated solutions for every type of sign needed within an exterior environment. Certain types of products may be better suited than others for specific signs, whether for reasons of cost, functionality or aesthetics.

Although some solutions may not fall within the AluTek family in terms of the components used for fabrication, they may all be used quite easily alongside one another to create a comprehensive and cohesive exterior sign program.



Flag Mount
5110 Series - Aluminum

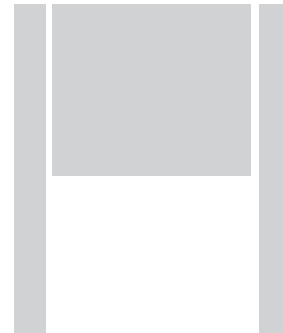

Double Post & Panel
5120 Series - Aluminum

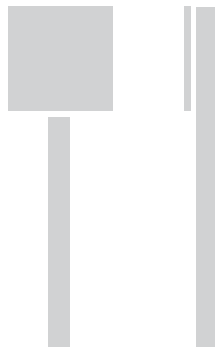

Flat Sheet Post Mount
4160.1 Series - Aluminum

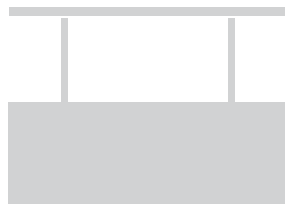

Overhead Signs
5170 Series - Aluminum



Flat Sheet Wall Mount
4160.3 Series - Aluminum