

Accord 15 is a complete, modular system ideal for virtually any signage need, from simple personnel and identification signs, to complex directionals and directories.

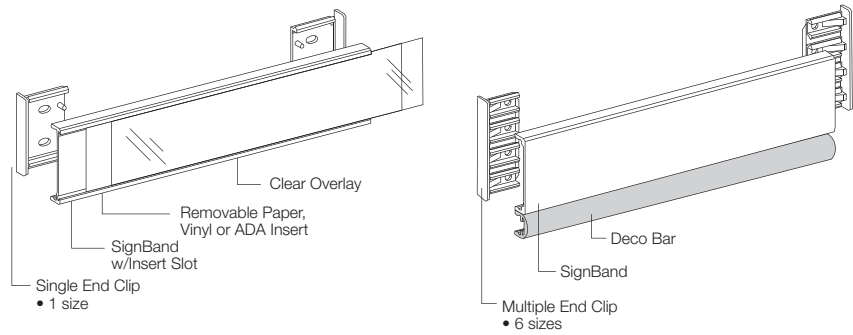

End Clip System

Features a wide range of extruded aluminum and molded plastic bands (inserts) and unique decorative elements which snap onto low profile (3/8"/9.5mm depth), integrally colored, injection molded End Clips. Ideal for personnel signs, directional modules, room identification, and ceiling and wall projection signs.



End Clips

Single Insert Clips (45mm)

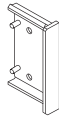

Square

Multiple Insert Clips* (60, 75, 90, 120, 150, & 210mm)

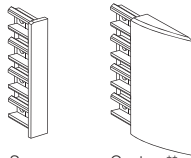

Square

Contour**

Inserts

(Snap onto End Clips)



SignBands
• 8 Standard Sizes
• Custom Sizes Possible
• Curved Face Option



SignBands w/Insert Slot
• 6 Standard Sizes
• Compatible with APCO SignWord paper inserts with laser printed copy or other changeable materials.



Decorative Elements
• 3 Options/Shapes

Worldwide Patent Protection

Side Track System

Features a wide range of aluminum and molded plastic bands which snap onto extruded aluminum Side Tracks via modular Clip fasteners, ensuring modularity and precise alignment of inserts. Ideal for room signs, directories, directional signs, poster holders, and more.

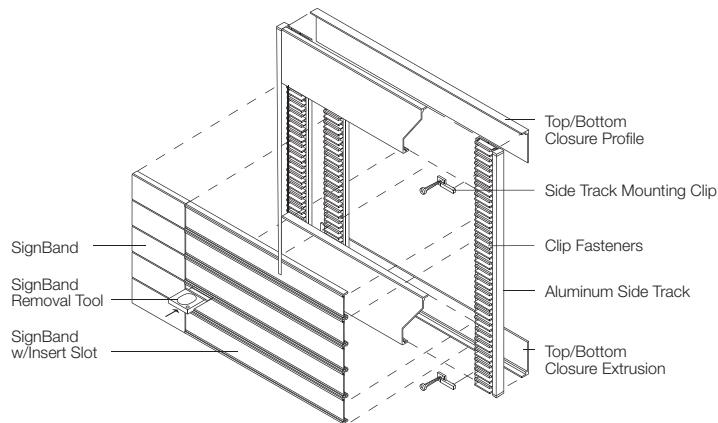

Aluminum Side Tracks

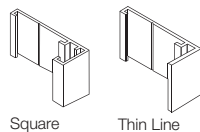

Square

Thin Line

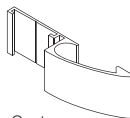

Contour

Clip Fasteners

(Lock into Side Track)

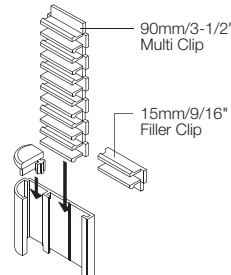

90mm/3-1/2" Multi Clip

15mm/9/16" Filler Clip

Inserts

(Snap onto Clips)

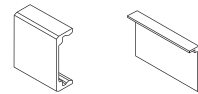

SignBands

Top/Bottom Closure Extrusion (Optional)



SignBands w/Insert Slot



Decorative Elements

Standard Heights

120mm (4-3/4") - 1005mm (39-1/2")

Important Note! Height Must Be in 15mm increments (Divisible by 15mm). Inch Dimensions are Nominal Only.

End Clip System - Applications

- Personnel Signs
- Information Signs
- Identification/Room Signs
- Conference Room Signs
- Directories
- Directionals



Side Track System - Applications

- Information Signs
- Identification/Room Signs
- Conference Room Signs
- Directories
- Directional Signs

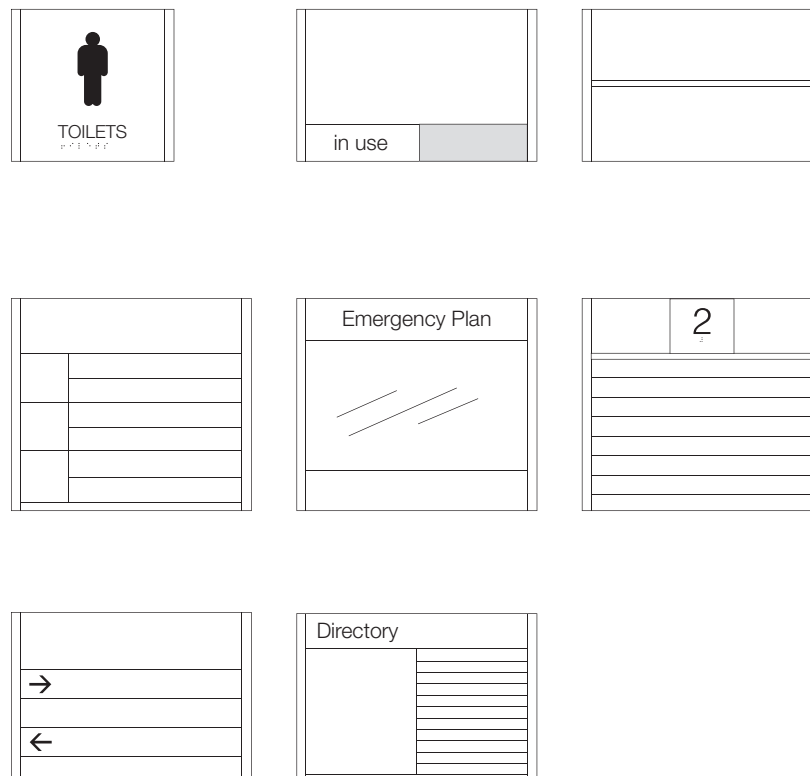

End Clip System

Single End Clips

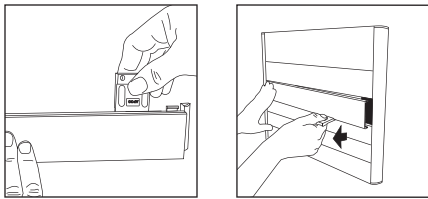
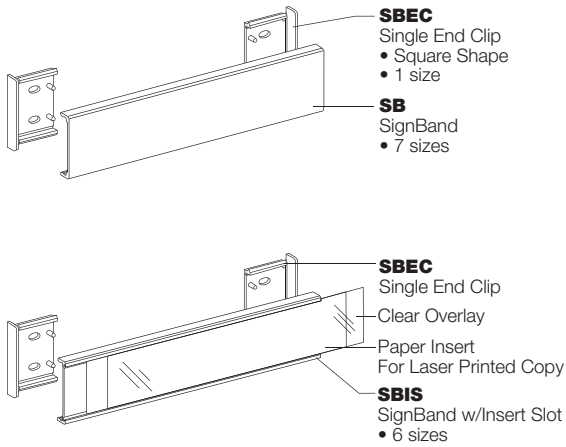

Insert Removal

Multiple End Clips

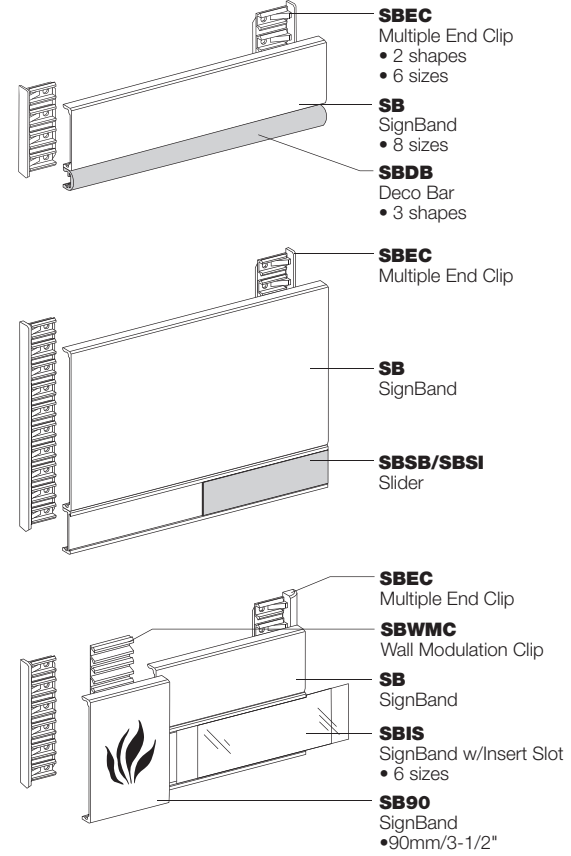

Molded Plastic End Clips

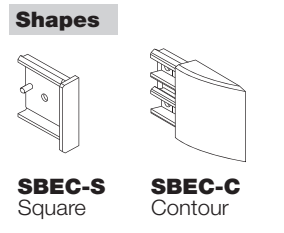

- Standard Colors**
Integral Colors
A02 Black
A72 Bone White
A78 Pearl Grey
Painted Colors
(44) Standard
Custom Colors

* Not available for Contour

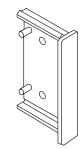

Side Track System

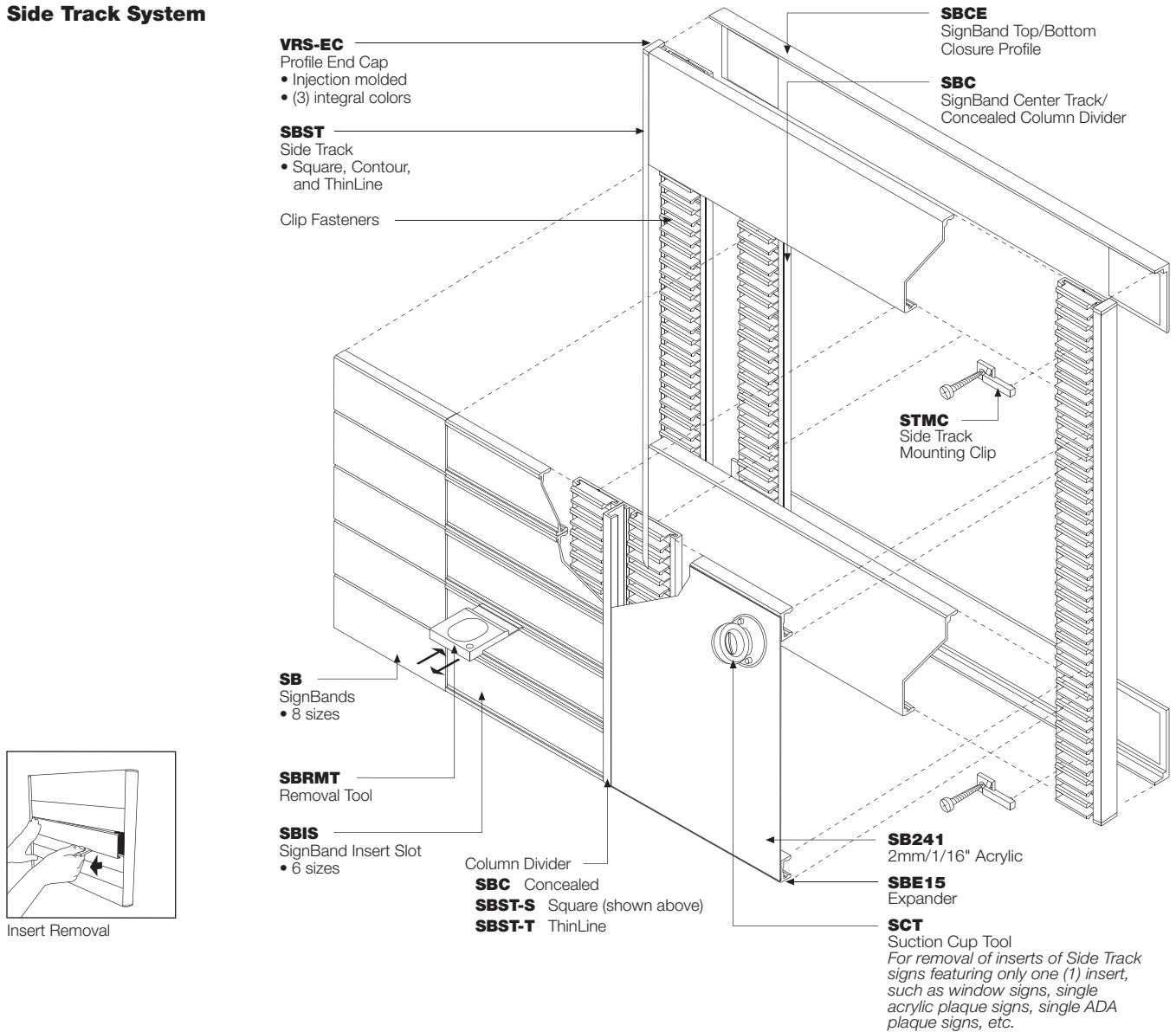

Aluminum Side Tracks

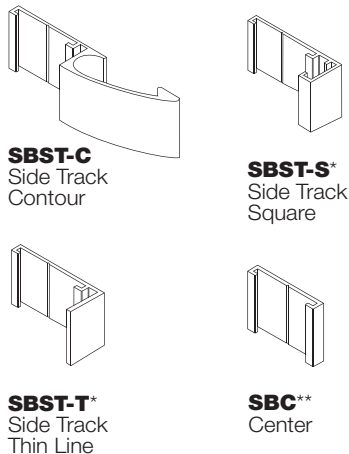

Colors/Finishes

Painted (Polyurethane)
(44) Standard
Custom Colors

Anodized
Natural Satin

* May also be used as Dividers.

**Metric
Conversion**
1" = 25.4 mm

Standard Heights

120mm (4-3/4") - 1005mm (39-1/2")

Important Note! Height Must Be in 15mm increments (Divisible by 15mm).
Inch Dimensions are Nominal Only.

SignBands

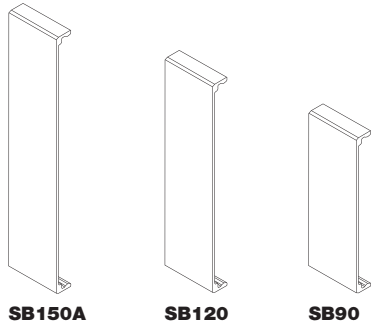

SB150A

SB120

SB90

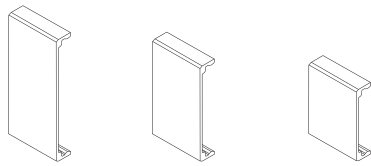

SB75A

SB60

SB45

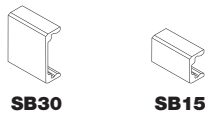

SB30

SB15

Part Code	Overall Height	Display Height	Standard Band Widths
SB150A	150mm (5-7/8")	148mm (5-15/16")	105mm or 4"
SB120	120mm (4-3/4")	118mm (4-11/16")	150mm or 6"
SB90	90mm (3-1/2")	88mm (3-7/16")	210mm or 8"
SBC75A	75mm (3")	72mm (2-13/16")	225mm or 9"
SB60	60mm (2-3/8")	58mm (2-15/16")	255mm or 10"
SB45	45mm (1-3/4")	43mm (1-11/16")	300mm or 12"
SB30	30mm (1-1/8")	28mm (1-1/16")	360mm or 14"
SB15	15mm (9/16")	13mm (1/2")	405mm or 16"
			450mm or 18"
			510mm or 20"
			600mm or 24"
			750mm or 30"
			900mm or 36"

Standard Colors/Finishes
 (44) Standard Polyurethane Coated
 Natural Satin Anodized
 Custom Colors Available

Metric Conversion
1" = 25.4 mm

SignBand Insert Slots



SB90IS

SB75IS

SB60IS



SB45IS

SB30IS

SB15IS

Part Code	Overall Height	Display Height	Standard Band Widths
SB90IS	90mm (3-1/2")	82mm (3-1/4")	105mm or 4"
SB75IS	75mm (3")	66mm (2-5/8")	150mm or 6"
SB60IS	60mm (2-3/8")	52mm (2-1/16")	210mm or 8"
SB45IS	45mm (1-3/4")	37mm (1-7/16")	225mm or 9"
SB30IS	30mm (1-1/8")	24mm (7/8")	255mm or 10"
SB15IS	15mm (9/16")	9mm (5/16")	300mm or 12"
			360mm or 14"
			405mm or 16"
			450mm or 18"
			510mm or 20"
			600mm or 24"
			750mm or 30"
			900mm or 36"

Standard Colors/Finishes
 A02 Black (44) Standard Polyurethane Coated
 A43 Putty Custom Colors Available
 A44 Architectural Brown
 A72 Bone White Natural Satin Anodized
 A78 Pearl Grey

Insert Options



SWMS*
 SignWord Paper
 Inserts w/Laser
 Printed Copy &
 Protective Overlay



SB010
 10mil Lexan
 w/Subsurface
 Graphics



SB020
 20mil Polyester
 w/applied background
 color and Surface
 Graphics



SBADA-DPT
 20mil Polyester
 w/Direct-Print raised
 characters and Braille

* Clear Protective Overlay is automatically included with factory produced and cut SignWord paper with Insert Slots unless otherwise specified.

ClearBand

Injection Molded Plastic

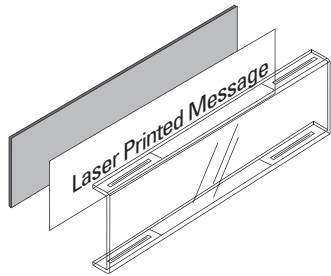

User Lettering Solution

Part Code	Overall Height	Display Height	Width
SBP30-225-CL	30mm (1-1/8")	24mm (7/8")	225mm (8-7/8")
SBP45-225-CL	45mm (1-3/4")	37mm (1-7/16")	225mm (8-7/8")
SBP60-150-CL	60mm (2-3/8")	52mm (2-1/16")	150mm (5-7/8")
SBP60-225-CL	60mm (2-3/8")	52mm (2-1/16")	225mm (8-7/8")
SBP150-150-CL	150mm (5-7/8")	147mm (5-3/4")	150mm (5-7/8")
SBP150-225-CL	150mm (5-7/8")	147mm (5-3/4")	225mm (8-7/8")

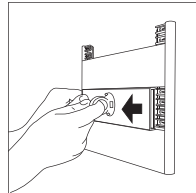

Insert Removal using APCO Suction Cup Tool (SCT)

Changeable Slide Options

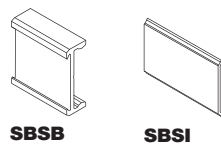

SBSB

SBSI

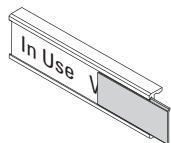

Part Code	Overall Height	Display Height	Standard Widths
SBSB w/SBSI	30mm (1-1/8")	24mm (7/8")	150mm or 6"

Copy Options for SBSB

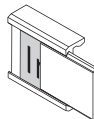

Standard
15mil vinyl inlay w/surface sprayed background and surface silkscreened copy

Standard Colors/Finishes

- A02 Black
- A43 Putty
- A44 Architectural Brown
- A72 Bone White
- A78 Pearl Grey

(44) Standard Polyurethane Coated
Custom Colors Available

Natural Satin Anodized

NOTE: SBSI is half the width of the SBSB standard width shown.

Decorative Elements

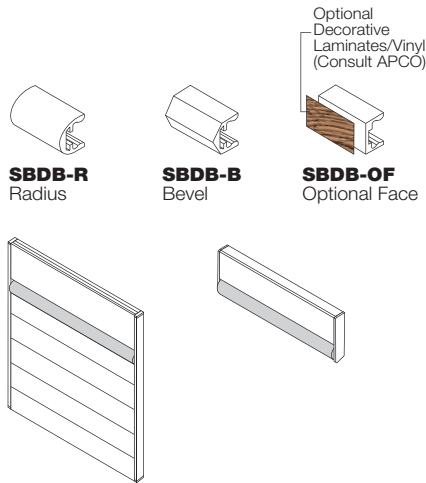

Part Code	Total Height
SBDB-R	15mm (9/16")
SBDB-B	15mm (9/16")
SBDB-OF	15mm (9/16")

Standard Widths
105mm or 4"
150mm or 6"
210mm or 8"
225mm or 9"
255mm or 10"
300mm or 12"
360mm or 14"
405mm or 16"
450mm or 18"
510mm or 20"
600mm or 24"
750mm or 30"
900mm or 36"

Standard Colors/Finishes

- A02 Black
 - A43 Putty
 - A44 Architectural Brown
 - A72 Bone White
 - A78 Pearl Grey
- (44) Standard Polyurethane Coated
Custom Colors Available
- Natural Satin Anodized

Acrylic Plaque Inserts

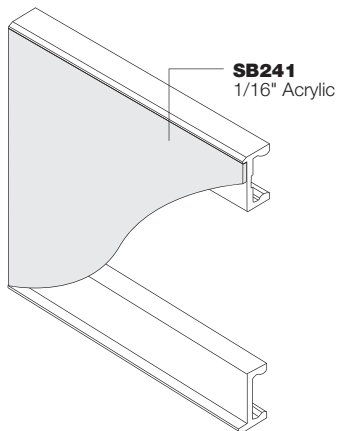

SB241 Height
180mm (7-1/16")
195mm (7-3/4")
210mm (8-1/4")
225mm (8-7/8")
255mm (10")
300mm (11-3/4")
360mm (14")
405mm (16")

Standard Widths
150mm or 6"
210mm or 8"
225mm or 9"
255mm or 10"
300mm or 12"
360mm or 14"
405mm or 16"
450mm or 18"
510mm or 20"
600mm or 24"
750mm or 30"
900mm or 36"

Metric Conversion
1" = 25.4 mm

Note: Consult APCO for custom sizes

**ADA Bands for SignBand
 Insert Slots**

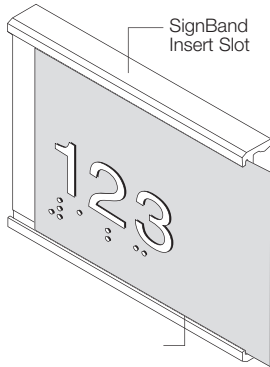

SBADA
 APCO's DP-Tactile process
 Direct Print UV-cured raised
 character Braille on painted
 20mil polyester

SBADA Height

45mm (1-3/4")

60mm (2-3/8")

90mm (3-1/2")

Standard Widths

45mm or 2"

105mm or 4"

150mm or 6"

210mm or 8"

225mm or 9"

255mm or 10"

300mm or 12"

Rigid ADA Plaques

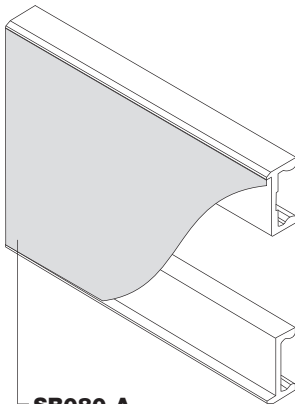

SB080-A
 .080" Rigid Plaque
 w/Direct Print raised
 characters and Braille

SB080-A Height

60mm (2-3/8")

90mm (3-1/2")

120mm (4-3/4")

150mm (5-7/8")

180mm (7-1/16")

195mm (7-3/4")

210mm (8-1/4")

225mm (8-7/8")

255mm (10")

300mm (11-3/4")

Standard Widths

150mm or 6"

210mm or 8"

225mm or 9"

255mm or 10"

300mm or 12"

360mm or 14"

SignWord Paper Inserts

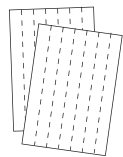
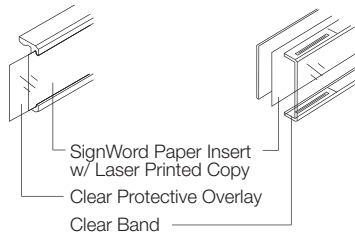

Code	Description	Stock Length*	Yield**
SWMS15	For 15mm Insert Slot	11" (280mm)	600/pack of 50 sheets
SWMS30	For 30mm Insert Slot & Clear Band	14" (355mm)	400/pack of 50 sheets
SWMS45	For 45mm Insert Slot & Clear Band	14" (355mm)	250/pack of 50 sheets
SWMS60	For 60mm Insert Slot & Clear Band	14" (355mm)	150/pack of 50 sheets
SWMS90	For 90mm Insert Slot	14" (355mm)	150/pack of 50 sheets
SWMS150	For 150mm Clear Band	11" (280mm)	50/pack of 50 sheets

* This is the maximum length/width. Paper inserts may be cut to smaller standard widths as specified.
 ** SignWord Paper Inserts and Clear Overlay are also available cut-to-size and printed by APCO. Clear Overlay is included with every factory produced and cut SignWord paper for Insert Slot unless otherwise specified.
 *** See pages 4.2.105-106 for full range of SignBand Insert Slots and Clear Bands which are compatible with these SignWord paper inserts.

SignWord[®] Paper Colors

- A72 Bone White / A00 White (on reverse)
- A43 Putty / A94 Sand (on reverse)
- A78 Pearl Grey
- A98 Pearl Grey Light

Custom colors available. Consult APCO



User Lettering Solution!

SWPRO
SignWord[®] Pro Software

Minimum System Requirements

- Windows 7, 8, or 10 Pro
- 16 MB RAM
- 5 MB free disk space
- Laser or Inkjet printer

3 Easy Steps

1 Create



With SignWord Pro Software, enter your message and symbols using pre-established formats or your own custom layouts.

2 Print

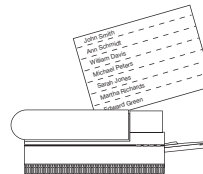

Print the image on a special paper that is perforated and colored to match the sign holder.

3 Insert

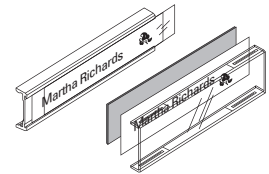

Punch out the sign insert and place it in the Insert Slot or Clear Band and PRESTO - in less than 60 seconds a complete sign!

Window Sign Solution!

For a wide range of aesthetically compatible and low-profile window sign solutions, see the award-winning **FullView** in **Section 4.3**.

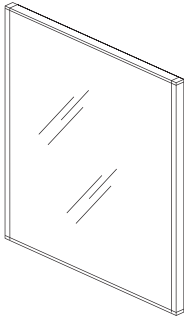

Projection Wall Sign Solution!

For a wide range of aesthetically compatible and low-profile projection wall sign solutions, see the award-winning **FullView** in **Section 4.3**.

Standard Plastic Panel Clip

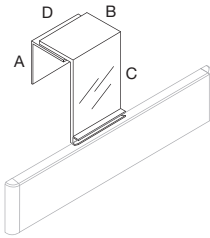

Code	Angle	Minimum Dimension	Maximum Dimension
SBPC	A	1-1/2"	1-1/2"
	B	1-1/8"	2-1/4"
	C	2"	2"
	D	3-5/8"	3-5/8"

Compatible End Clip Heights: All to 210mm

SBPC
Panel Clip

A clear, plastic clip snaps onto return of SignBand. Width (B) adjustable by attaching two separate legs with clear double-sided tape.

Custom Aluminum Panel Clips

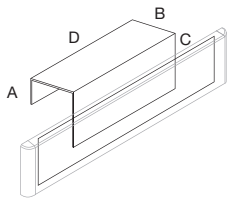

Code	Angle	Minimum Dimension	Maximum Dimension
SBPCA-AB	A	1/2"	1"
	B	1"	3"
	C	0"	3"
	D	2"	4"

Compatible End Clip Heights: All to 210mm

SBPCA-AB
Aluminum Clip / Aluminum Backer

An EndClip sign is attached to an aluminum backplate via double-sided tape. A custom-formed aluminum panel clip is then adhered to the back of the sign assembly via double-sided tape.

Standard Colors/Finishes
Natural Satin Anodized
Painted
- 44+ Standard
- Custom

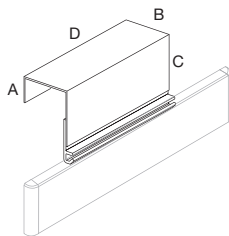

Code	Angle	Minimum Dimension	Maximum Dimension
SBPCA-SN	A	1/2"	1"
	B	1"	3"
	C	0"	3"
	D	2"	4"

Compatible End Clip Heights: All to 210mm

SBPCA-SN
Aluminum Clip / Snap Fit to SignBand

The "snap" portion of a standard SBPC Panel Clip is attached to the bottom face of a custom-formed aluminum panel clip. That assembly is then attached/snapped to upper or lower return of a SignBand or

Standard Colors/Finishes
Natural Satin Anodized
Painted
- 44+ Standard
- Custom



PIN-U
PinLock Fasteners

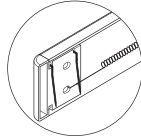

For Fabric Surfaces

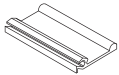

SBDSE
Desk Sign Extrusion
(Black Plastic)



For 30mm or 45mm Desk Signs.

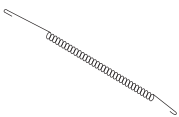

SBECs
End Clip
Support Spring

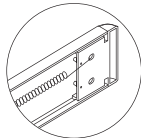

For Desk Sign & Office Partition/Panel Clip signs. Consult APCO to see if spring is recommended for your application.

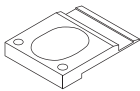

SBRMT
SignBand
Removal Tool

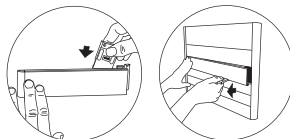

For removal of SignBands & SignBand Insert Slots.

Important Note: Please consult APCO or visit the APCO website for detailed instructions for proper removal and replacement of Accord inserts. If proper procedure is not followed correctly, damage to sign may occur.

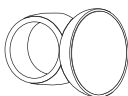

SCT
Standard Suction
Cup Tool

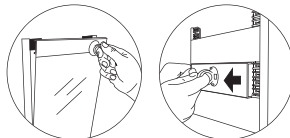

For insert removal of single insert SideTrack signs, Poster Holder/EP/Window Sign inserts and Accord 15 Express Color Band and Clear Bands.

Product Instructions

(Consult APCO or visit the APCO website @ www.apcosigns.com)