

# HealthView™

INFECTION CONTROL STATION  
HPS100 - Wall Mount Series

## Assembly Instructions

HealthView should be located near key areas that maximize exposure to intended users. Installation is quick and easy. Two aluminum mounting rails support the cabinet for a positive attachment.

### Important Note Regarding ADA Compliance

The HealthView Series 100 Dispenser Cabinet features a depth of 5.06". If mounted within a facility's "circulation route" (i.e. corridor, stairwars, etc.), it must either be 1) mounted so that the bottom of the cabinet is lower than 27" above the floor surface, or 2) accompanied by a HealthView WasteBin which extends lower than 27" above the floor surface. For more details, please consult APCO.

### Prepare Cabinet for Installation

1. First remove the Face Plate, by lifting upward & pulling out using the Tissues/Masks opening slot. If your cabinet does have a slot, use the Suction Cup Tool (SCT) provided in this package. (Fig. 1) Remove plate and set aside any loose contents.

**Note:** If your product includes the optional Tamper Proof Locking Pin, follow the instructions in the upper right corner of the cabinet & remove the locking pin using the magnetic removal tool provided.

2. Locating the Top Mounting Rail. (Fig. 2 & 3)  
Select the longer of the two mounting rails. Position it inside the top of the cabinet housing, and, while holding it in position, place against the wall or intended mounting surface. Use a small level to insure the cabinet housing is level. Recommended reach height is approximately 42"
3. Transfer the hole locations to the mounting surface with a pencil or awl, then remove the cabinet housing and rail so that appropriate wall anchors or fasteners may be installed.

### Cabinet Installation

4. Affix the Top Mounting Rail with a minimum of (2) screws as shown. *Do not tighten firmly at this time*, leaving screw heads 1/2" from wall or mounting surface. (See Fig. 4) This will allow the Cabinet to engage in Mounting Rail, after which the screws may be fully tightened.
5. Place lower Mounting Rail in position and transfer hole pattern. Insert anchors, screws and tighten. (Fig. 5) Cabinet installation is now complete

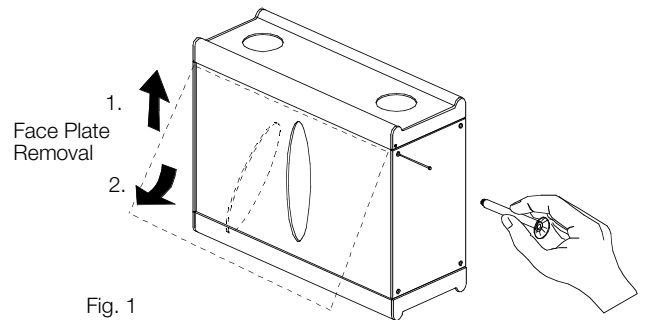

Fig. 1

Note: Use the magnetic tool provided to remove the pin.

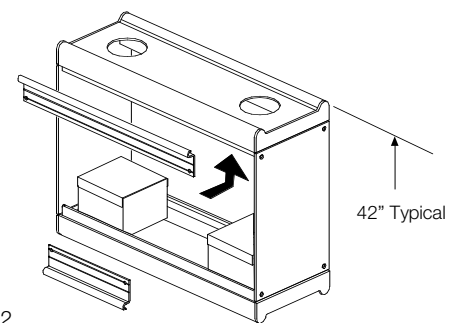

Fig. 2

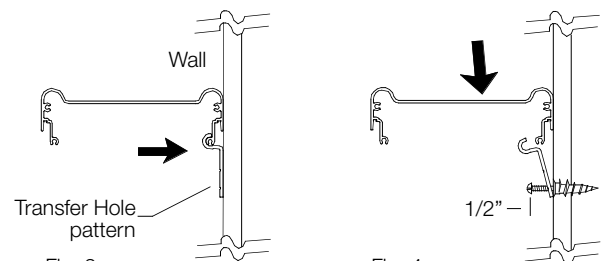

Fig. 3

Fig. 4

### Installation and Assembly Components



#### Wedge OR Box Lifter(s)

- Depending upon specific brands of hand gel foam or wipes being used
- Slides under hand foam/gel/wipes to create a secure fit withing the cabinet.

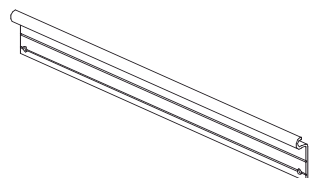

Top Mounting Rail

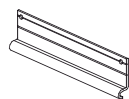

Lower Mounting Rail

#### Hardware Provided (2 per mounting rail):

- E-Z Wall anchor steel
- # 8 x 1-1/4" Pan Phil SMS - Zinc Type A

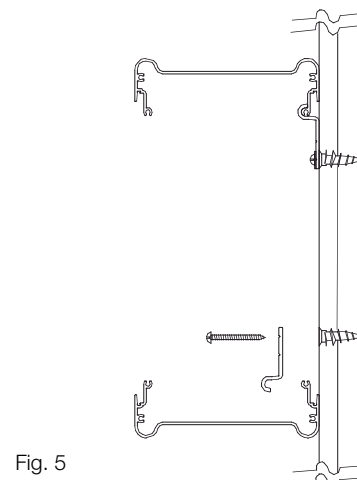

Fig. 5

**IMPORTANT:** Your HealthView product was engineered and manufactured to accommodate specific brands of infection control products as established during your pre-order communication with APCO and as described in the APCO Order Acknowledgment you received. Other brands of infection control products may not be compatible with your HealthView product as currently engineered.

### Hand Foam/Gel

With Face Plate removed, insert top handle through circular hole in cabinet top. Hold the container with one hand while inserting the Lifter beneath.

The Lifter will provide lift and pressure to the foam pump device. (Fig. 6) Push Lifter fully into the cabinet.

\* Box Lifter may be provided depending upon the brand of foam/gel being used withing your dispenser cabinet.

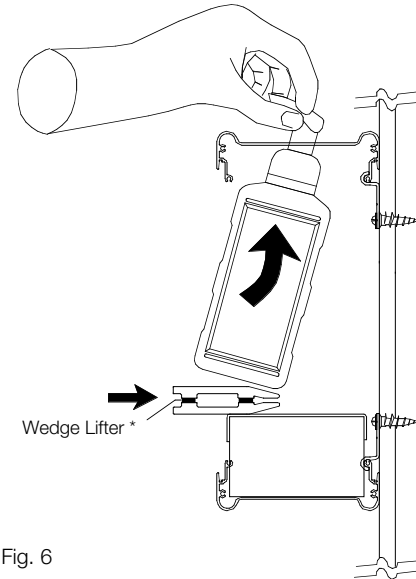

Fig. 6

### Wipes

With Face Plate removed, slip container under large hole and rotate container to align to shape. Press Wedge Lifter under container base. (Fig. 7)

Caution: Be sure Wipes "Cap Hinge" is toward the back of the cabinet.

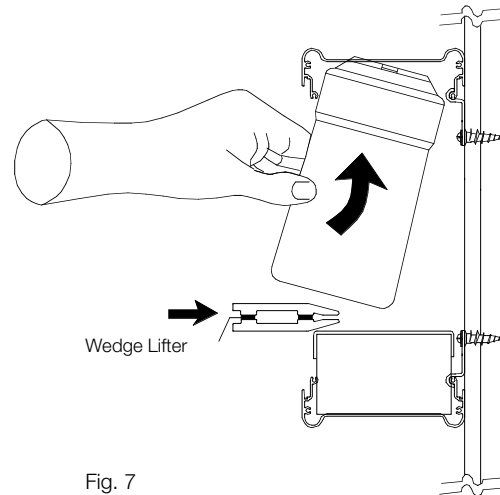

Fig. 7

### Tissue

With Face Plate removed, use two 2" boxes and slip in cabinet, top first as shown. Tissue boxes rest on a flat plate in the bottom of cabinet. (Fig. 8) Always used two (2) boxes to keep dispensing forward

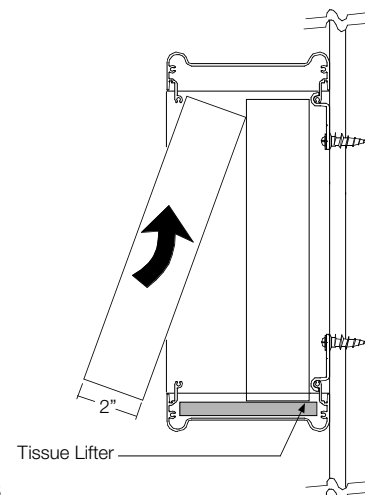

Fig. 8