

Visulex® 2100 Series Non-Illuminated Wall and Pylon Module



Cleaning & Maintenance Guide

Cleaning - General

The finish and graphics on your Visulex product may be scratched and damaged if not cleaned properly. Please read carefully.

Cleaning Clear Plastic Cover

IMPORTANT: Remove the plastic cover before cleaning. Follow instructions below.

The Visulex Plastic Cover is coated with a scratch and abrasion resistant coating. The recommended cleaning solution is called Brillianize which is spray applied antistatic cleaner and polish designed for acrylic surfaces. When used with a soft lint free cloth, it will help resist finger markings while preventing build up of dust and dirt. A container has been supplied with the product. When supply is exhausted, it may be purchased from a local acrylic supplier. **NOTE:** Always follow product instructions.

Strong, ammonia based window cleaners and other solvents are not recommended and may damage the plastic.

Should the cover become damaged, a replacement may be ordered by contacting your local APCO Representative or by calling (404) 688-9000.

Cleaning Module Surfaces

The Visulex module, or housing, is molded of a durable, seamless fiberglass and coated with an automotive grade finish. Occasional cleaning with a mild solution of soap and water will keep your Visulex looking its best for years to come.

Avoid using harsh cleaners, abrasives or any solutions that may contain solvents that will be harmful to the finish.

Should the housing finish become chipped or severely scratched, touch-up paint may be ordered by contacting your local APCO Representative or by calling (404) 688-9000.

Cleaning Decorative Trim Surfaces

Painted Finishes:

Clean only with a mild solution of liquid dish detergent and lukewarm water. Use a clean, soft cloth or soft sponge. **DO NOT** use conventional metal cleansers and polishes as they will destroy the finish and its protective coating.

Natural Satin, Black & Bronze Anodized Finishes:

Dry with a damp cloth or damp chamois. Note: When minor scratches appear on black or bronze finishes, a blemish remover can be provided. Consult Factory.

Polished Aluminum, Brass & Chrome Plated Finishes:

Do Not use conventional metal cleaners as they will destroy the finish and protective coating. Dry by blotting with a damp cloth or damp chamois. Do Not dry by rubbing.

Additional Information

Contact APCO at (404) 688-9000 for Technical Assistance relating to this product.

Removing Clear Plastic Cover

Parts supplied:	Qty.
Suction Cup Tool (SCT)	1

Step 1 Attach Suction Cup Tool (SCT) to face of Plastic Cover. Press center of Suction Cup to achieve a vacuum-type bond.

Step 2 Lift upward until cover clears the bottom channel, then pull outward at the bottom to remove cover.

Step 3 To release the SCT from the cover, compress the two protruding 'nibs' at the base of the cup.

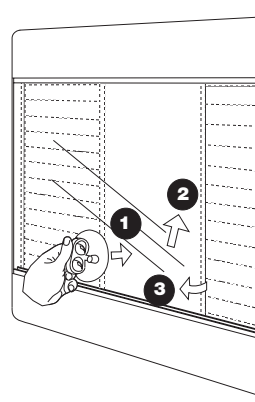

Wall mount module shown.
Pylon module typical.



Servicing Products with I50 and I100 Message Strips

Step 1 Locate the Plastic Message Strip to be changed. Slide all strips above it upwards with one hand. Using the other hand, flex the strip outward at the center until it disengages from the Vertical Column Dividers.

Step 2 To install an I50 or I100, insert one end of strip under Vertical Column Divider. Carefully flex the strip until the other end slips beneath the opposing Divider.

Note: If blue MessageBand Removal Tool is included, it is not needed with this feature.

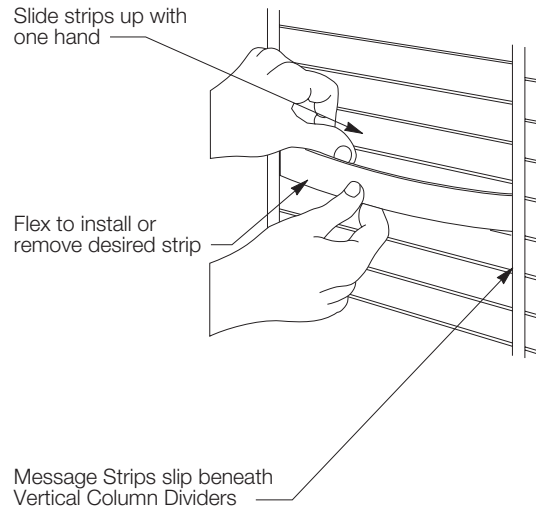
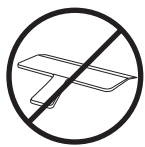

Servicing Products with Insert Slot Feature

Tools supplied: Qty.
 MessageBand Removal Tool (MRT)..... 1

Step 1 Using the blue MessageBand Removal Tool provided, lift the entire message column assembly upward until it clears the bottom channel Trim.

Step 2 Pull outward to remove column assembly.

CAUTION: Handle column assemblies in an upright position to prevent message inserts from accidentally sliding out.

Step 3 Place column assembly on a flat surface. Message inserts can now be changed by sliding out the open end of the slots.

Step 4 Replace MessageBands by reversing Steps 1 and 2.

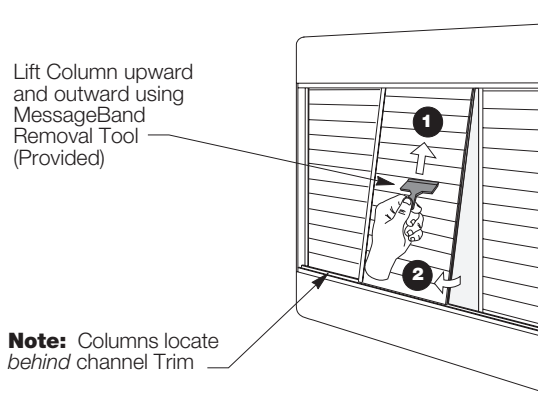
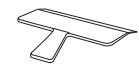

Aluminum MessageBand with Insert Slot Feature

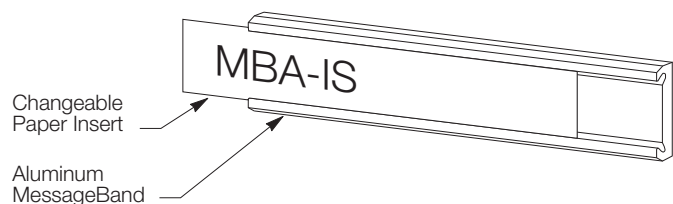



Servicing Products with Plastic MessageBands

Tools supplied: Qty.
 MessageBand Removal Tool (MRT)1

Step 1 Insert the blue MessageBand Removal Tool provided between MessageBands. Slide the tool to the left or right, close to the end, and flex to release the outermost PresLock fasteners from their track. After one end is released, carefully unsnap the remaining fasteners, moving from one end to the other, so as not to bend or break the MessageBand.

Preslock Fastener Application

Proper cleaning of application surface must be performed prior to applying all PresLock fastener. This is essential to insure proper adhesion. DO NOT sand or scuff surfaces to which PresLocks will be applied.

Step 2 Remove dirt, oils and paint overspray from new MessageBand ideally using a 50-50 solution of Isopropyl alcohol and water. Allow time for mixture to evaporate prior to PresLock application. *If MessageBands are plastic rather than aluminum, this step may be omitted.*

Step 3 Locate and snap new PresLocks into the aluminum track. Peel off the protective backing, exposing the adhesive pad. DO NOT touch the uncovered adhesive! Natural skin oil will greatly reduce its effectiveness.

Step 4 Carefully align MessageBand over new PresLocks and press into position. It is necessary to apply firm pressure over the PresLock area to properly adhere the fastener to the back of the MessageBand.

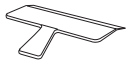

Aluminum track accepts PresLock fasteners

Step 1
 Using MessageBand Removal Tool (Provided), lift outward to disengage PresLocks

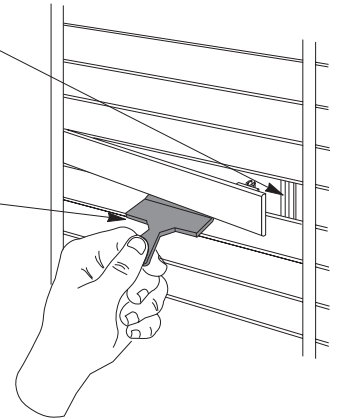

Step 2
 Clean With Isopropyl Alcohol & Water (50-50 Mixture)

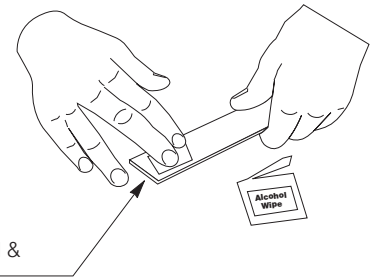

Step 3
 Snap New PresLocks Into Track & Remove Protective Backing

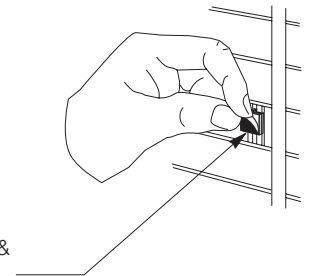

Step 4
 Apply firm pressure over PresLock area

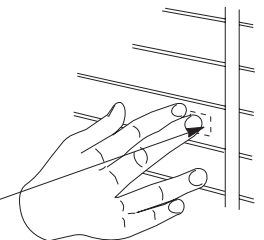



Servicing Products with Maps and Plans

Generally, Maps and Plans do not require servicing unless they are being replaced. If replacement is necessary, follow these steps.

Parts supplied: Qty.
Suction Cup Tool (SCT)1

Step 1 Attach Suction Cup Tool (SCT) at corner of Map or Plan insert. Press center of Suction Cup to achieve a vacuum-type bond.

Step 2 Gently pull outward until insert detaches from its magnetic grip.

IMPORTANT: Most inserts are constructed of thin plastic sheet. Care must be taken to avoid over-bending, thus causing possible breakage.

Step 3 To release the SCT from the insert, compress the two protruding 'nibs' at the base of the cup.

Step 4 Insure the new insert's magnetic tape is clean and dry. Align one edge of insert into desired position and gently press into place.



Cleaning

The Map or Plan insert can be cleaned with a mild solution of liquid dish detergent and lukewarm water or common window cleaner. Avoid using harsh cleaners, abrasives or any solutions that may contain solvents that will be harmful to the finish. Do Not clean by rubbing. Blot dry only using a damp cloth or damp chamois.

Servicing Products with Magnetic Bulletin Board

The foundation of the Magnetic Board is not removable. Round, low-profile magnetic "buttons" were provided with the product and are easily repositionable.

Cleaning

The board's plastic face can be cleaned with a mild solution of liquid dish detergent and lukewarm water or common window cleaner. NOTE: Do Not allow window cleaner to contact adjacent surfaces as this may be harmful to the finish.

Insure all magnetic "buttons" are clean and dry prior to use.

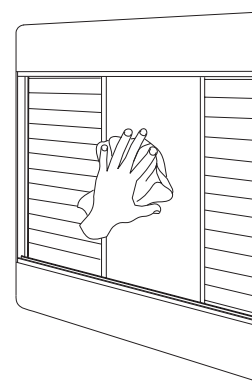

Servicing Products with LetterGrip Changeable Letter Board

When LetterGrip is displayed in the Visulex product, the Letter Board is not removable. Molded plastic LetterGrip letters can be inserted into the "ribbed" rubber in virtually any position.

Cleaning

The rubber can be cleaned with white spirit (mineral spirits) or bestine. NOTE: Always follow manufacturer's safety and handling instructions. Avoid contact with adjacent surfaces as these cleaners may harm the finish.

Servicing Products with CorkBoard

The CorkBoard foundation is not removable. Round head, low profile "map tacks" were provided with the product and are easily repositionable. Common thumb tacks can be used. However, push pins are not recommended due to the shallow display depth.

Cleaning

The board's face can be cleaned with soap and water, white spirit (mineral spirits) or bestine. NOTE: Always follow manufacturer's safety and handling instructions. Avoid contact with adjacent surfaces as these cleaners may harm the finish.