

To insert material

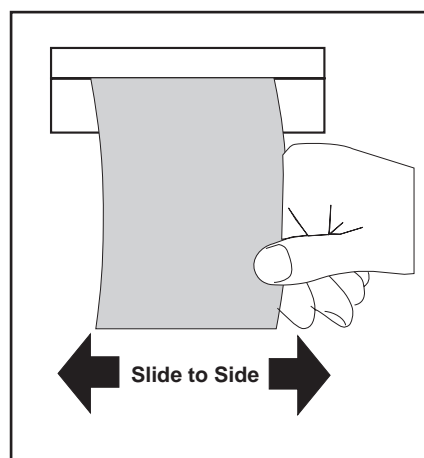

To remove material

Affixing Instructions

1. Using a level, mark position with light pencil marks.
2. Assure surface is smooth and free of oils, wax, dust.
3. Remove tape backing and press Notifier into position. Once in position, press firmly along tape line for optimum adhesion.

CAUTION:

Avoid using in areas where draft may vibrate insert material loose. Affixing to doors is not recommended, as opening and closing may cause paper insert material to release. Doors with speed control closure devices are usually more suitable.