

# Visuline® 2300.3GC Series

## Surface Mounted Display



**SUBMITTED FOR APPROVAL**

This product is scheduled for shipment the week of :

Date \_\_\_\_\_

Production cannot begin until one (1) copy of these drawings is returned with your signature of approval by :

Date \_\_\_\_\_, otherwise rescheduling will be necessary. Drawing revisions may also require rescheduling.

Retain \_\_\_\_\_ Set(s)

Return \_\_\_\_\_ Set(s)

**Customer Approval Required** *(Check appropriate box)*

Purchaser \_\_\_\_\_

By (Print name & title clearly) \_\_\_\_\_

Signature \_\_\_\_\_ Date \_\_\_\_\_

Approved for Production

Approved as noted

Not approved  
Resubmit with changes  
Product subject to rescheduling

**FOR REFERENCE ONLY** *(Customer Waives Approval)*

### Production Has Begun

This product is scheduled for shipment the week of :

Date \_\_\_\_\_

It is understood that customer, in waiving formal approval procedure, assumes full responsibility for the specifications, dimensions and details included herein.

### APCO Use

Project Name \_\_\_\_\_ **APCO Order No.** \_\_\_\_\_

Customer Order No. \_\_\_\_\_

Original Submittal Date : \_\_\_\_\_

Prepared by (Print clearly) \_\_\_\_\_

Revision (Date) \_\_\_\_\_

All design rights reserved.

# Visuline® 2300.3GC Series

## Surface Mounted Display



### Product Details

#### Section : Plan View

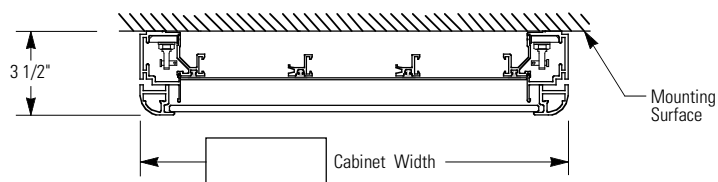

#### Cut-away Isometric View

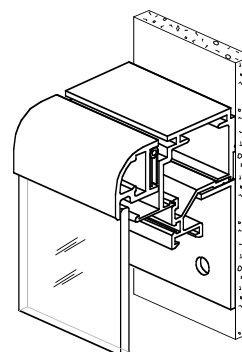

#### Elevation : Front View

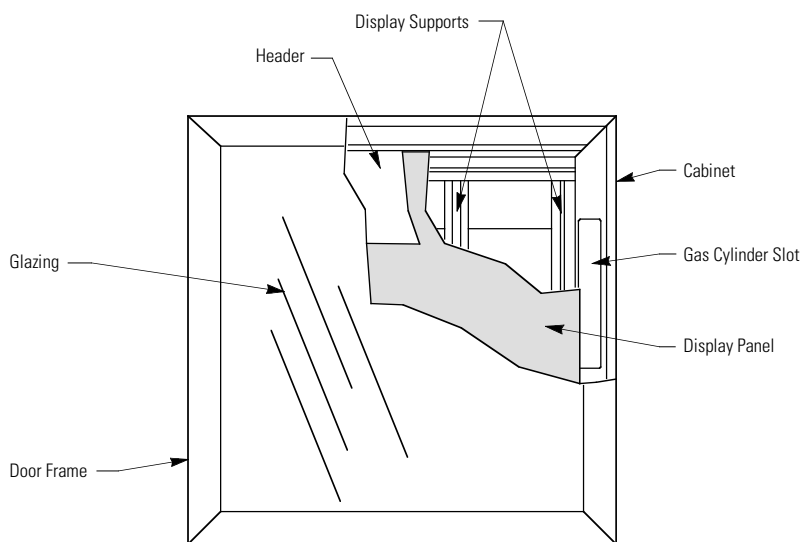

#### Section : Side View

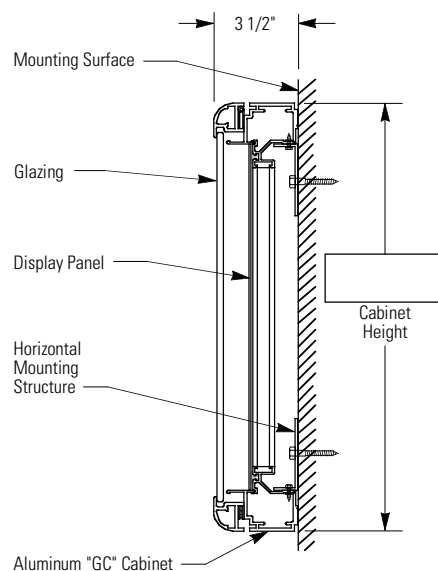

#### Door Profile Options

All shapes available in aluminum. Brass available in SD, RD & BD only.

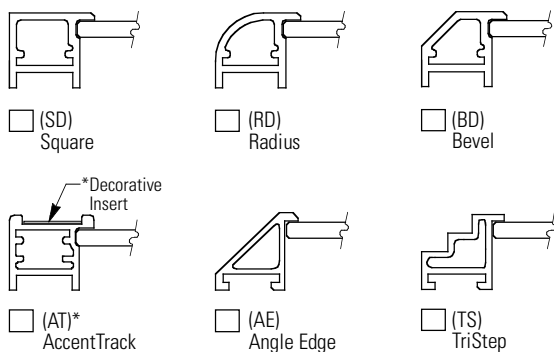

\* AccentTrack door accommodates insert materials 1" wide and up to .090" thick, furnished either by APCO or by customer.

#### Gas Cylinder "Assists"

"GC" Cabinets are specifically designed for heavy, top hinged doors.

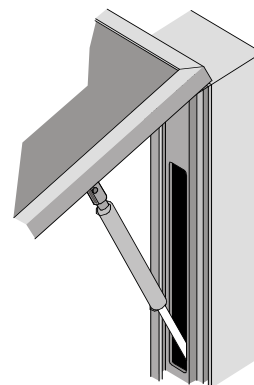

# Visuline® 2300.3GC Series Surface Mounted Display



## Specifications

### Product

- Interior Use
- Exterior Use

Size: H. \_\_\_\_\_ W. \_\_\_\_\_ D. 3-1/2"

Estimated Weight \_\_\_\_\_

### Door Frame Shape

- Square
- Radius
- Bevel
- AccentTrack
- AngleEdge
- TriStep

### Hinge Location

- Top (Standard)  
*(Opens approx. 60°, 75° or 90°, depending on door size & shape)*
- Other \_\_\_\_\_

### Door Locking Device

- 3M "Dual Lock" Fastener (Standard)
- Special "APCO Concealed Lock"
- Keyed Plunger Lock

### Glazing

- Clear Tempered Glass (Standard)  
*(See Note 3)*
- Other \_\_\_\_\_

#### Note 1

Dimensions for determining display area are calculated by subtracting 3-3/8" from both the cabinet housing's height and width.

Height \_\_\_\_\_ - 3-3/8" = \_\_\_\_\_ (Display Area)      Width \_\_\_\_\_ - 3-3/8" = \_\_\_\_\_ (Display Area)

#### Note 2

Clear glass has a natural slight green tint. Though typically unnoticeable, it may affect the appearance of certain colors.

#### Note 3

All display components are available for interior use. Refer to Product Technical Manual for those components approved for exterior applications.

### Finishes

#### Door

- Natural Satin Anodized
- 313 Dark Bronze Anodized
- 315 Black Anodized
- Other \_\_\_\_\_

#### Housing

- Natural Satin Anodized
- 313 Dark Bronze Anodized
- 315 Black Anodized
- Other \_\_\_\_\_

### Special Comments

\_\_\_\_\_

\_\_\_\_\_

\_\_\_\_\_

\_\_\_\_\_

\_\_\_\_\_

\_\_\_\_\_

\_\_\_\_\_

\_\_\_\_\_

\_\_\_\_\_

\_\_\_\_\_

### Display Components

See Notes 1 & 3

- Single Component Configuration
- Multiple Component Configuration  
*(Provide Format)*

#### Header

- With Header
- Without Header

Size: H. \_\_\_\_\_ W. \_\_\_\_\_

#### Directory

##### Informer Message Strips (Molded Plastic)

- I-50; 1/2" x 9"

Color: \_\_\_\_\_ Total Qty.: \_\_\_\_\_

- I-100; 1" x 9"

Color: \_\_\_\_\_ Total Qty.: \_\_\_\_\_

#### Accord15™ SignBands

Part Code	Length	Color	Qty.

#### Accord15™ SignBands w/ Paper Insert

Part Code	Length	Color	Qty.

#### Maps or Plans

Size: H. \_\_\_\_\_ W. \_\_\_\_\_

#### Magnetic Board

Size: H. \_\_\_\_\_ W. \_\_\_\_\_

Color: \_\_\_\_\_

#### Cork Board

Size: H. \_\_\_\_\_ W. \_\_\_\_\_

Color: \_\_\_\_\_

#### Fabric Board

Size: H. \_\_\_\_\_ W. \_\_\_\_\_

Color: \_\_\_\_\_

#### Custom Components

- Complete Specifications Provided

# Visuline® 2300.3GC Series Surface Mounted Display



## Installation / Mounting Details

### Section : Plan View

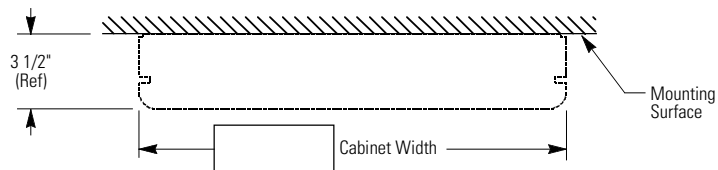

**IMPORTANT :**  
**APCO IS NOT RESPONSIBLE FOR DESIGN OR CONSTRUCTION OF WALL STRUCTURE OR MOUNTING SURFACE.**  
 Adequate wall structure for mounting directory must be provided by others.

### Elevation : Front View

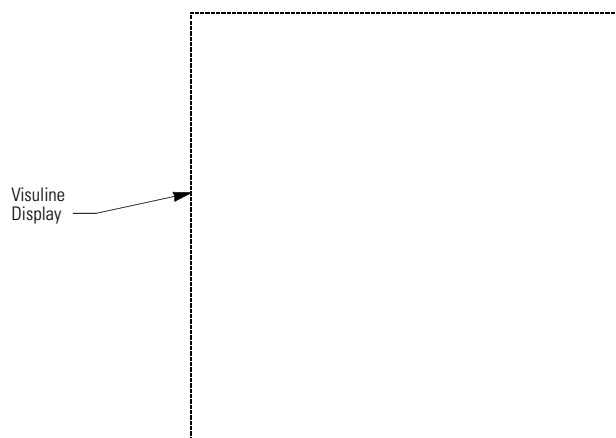

### Section : Side View

