

# Visuline® 2300.2 Series

## Full Recessed Display



**SUBMITTED FOR APPROVAL**

This product is scheduled for shipment the week of :

Date \_\_\_\_\_

Production cannot begin until one (1) copy of these drawings is returned with your signature of approval by :

Date \_\_\_\_\_, otherwise rescheduling will be necessary. Drawing revisions may also require rescheduling.

Retain \_\_\_\_\_ Set(s)

Return \_\_\_\_\_ Set(s)

**Customer Approval Required** *(Check appropriate box)*

Purchaser \_\_\_\_\_

By (Print name & title clearly) \_\_\_\_\_

Signature \_\_\_\_\_ Date \_\_\_\_\_

Approved for Production

Approved as noted

Not approved  
Resubmit with changes  
Product subject to rescheduling

**FOR REFERENCE ONLY** *(Customer Waives Approval)*

### Production Has Begun

This product is scheduled for shipment the week of :

Date \_\_\_\_\_

It is understood that customer, in waiving formal approval procedure, assumes full responsibility for the specifications, dimensions and details included herein.

### APCO Use

Project Name \_\_\_\_\_ **APCO Order No.** \_\_\_\_\_

Customer Order No. \_\_\_\_\_

Original Submittal Date : \_\_\_\_\_

Prepared by (Print clearly) \_\_\_\_\_

Revision (Date) \_\_\_\_\_

All design rights reserved.

# Visuline® 2300.2 Series Full Recessed Display



## Product Details

### Section : Plan View

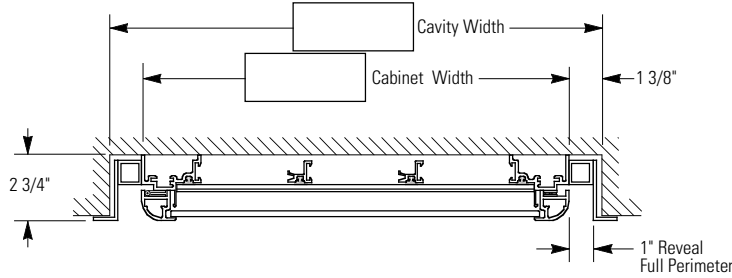

### Cut-away Isometric View

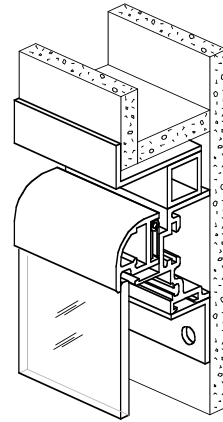

### Elevation : Front View

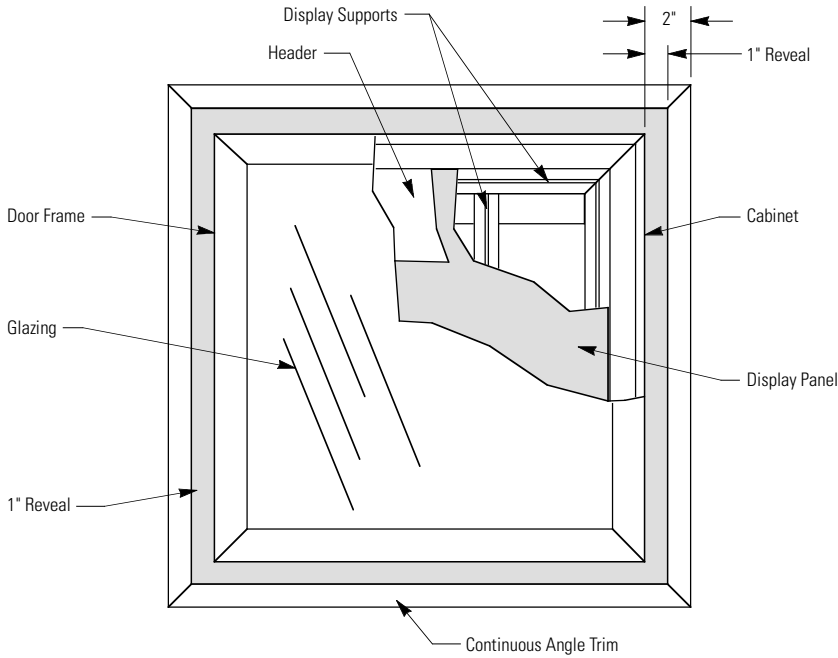

### Section : Side View

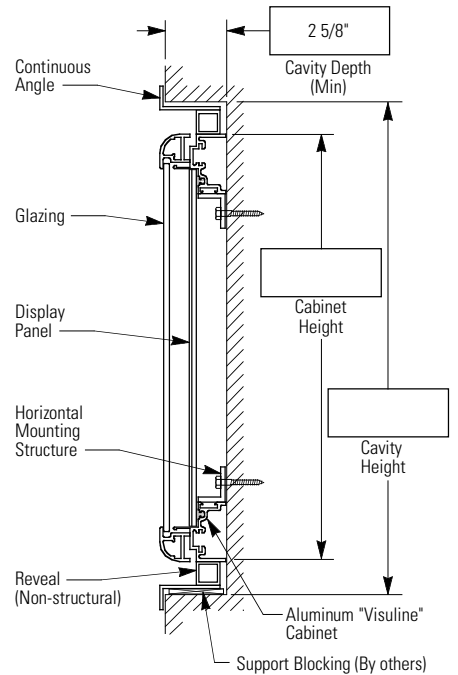

### Door Profile Options

All shapes available in aluminum. Brass available in SD, RD & BD only.

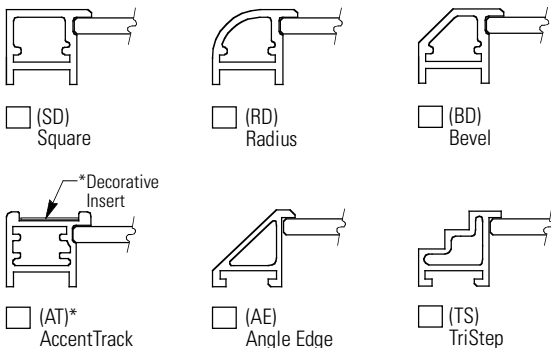

\* AccentTrack door accommodates insert materials 1" wide and up to .090" thick, furnished either by APCO or by customer.

### Prop Rods

Top hinged doors up to 30 lbs. are equipped with concealed prop rods.

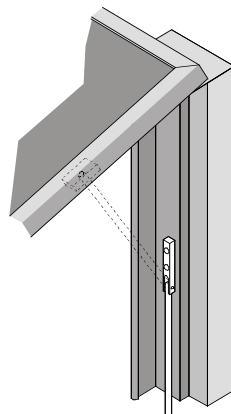

### Door Operating Clearance

A 1" wide Reveal (tube) is attached to the cabinet at a 1-1/2" depth to maintain proper door operation. A decorative, non-structural trim is then attached to the tube.

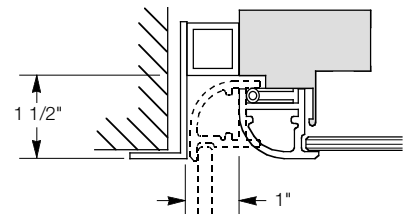

**IMPORTANT :**  
See "Installation / Mounting Details" page to determine Cavity Dimensions.

# Visuline® 2300.2 Series Full Recessed Display



## Specifications

### Product

- Interior Use
- Exterior Use

Size: H. \_\_\_\_\_ W. \_\_\_\_\_ D. 2-3/4"  
(See Note 4)

Estimated Weight \_\_\_\_\_

### Wall Cavity

See Note 1

- Existing Cavity
- To Be Constructed

Size: H. \_\_\_\_\_ W. \_\_\_\_\_ D. \_\_\_\_\_

### Door Frame Shape

- Square
- Radius
- Bevel
- AccentTrack
- AngleEdge
- TriStep

### Hinge Location

- Left
- Top with Prop Rod Door Supports  
(Opens approx. 60°, See Note 4)
- Other \_\_\_\_\_

### Door Locking Device

- 3M "Dual Lock" Fastener (Standard)
- Special "APCO Concealed Lock"
- Conventional Keyed Cam Lock

### Glazing

- Clear Tempered Glass (Standard)  
(See Note 3)
- Other \_\_\_\_\_

### Note 1

Wall cavity size is determined by adding cabinet housing, surrounding reveal, trim and installation clearance. Trim styles and cavity opening calculations for each are illustrated on "Installation / Mounting Details" page.

### Note 2

Display area is calculated by subtracting 3" from both the cabinet housing's height and width. (Also See Note 4)

Height \_\_\_\_\_ - 3" = \_\_\_\_\_ Width \_\_\_\_\_ - 3" = \_\_\_\_\_  
(Display Area) (Display Area)

### Note 3

Clear glass has a natural slight green tint. Though typically unnoticeable, it may affect the appearance of certain colors.

### Note 4

Top hinged aluminum doors exceeding 8.5 sq.ft. and top hinged brass doors exceeding 5.7 sq.ft. require gas cylinder "assistants". To accommodate gas cylinders, the "GC" cabinet is required. This variation affects product depth and size of display area. Use separate Shop Drawing 2300.2GC to specify the heavier, top hinged, Full Recessed Visulines.

### Note 5

All display components are available for interior use. Refer to Product Technical Manual for those components approved for exterior applications.

### Continuous Angle / Trim

See Note 1

- 1" Wide Angle (Standard)
- 1/8" Wide "Flat Bar" Trim
- Omit Angle / Trim (1" Reveal Remains)
- Other \_\_\_\_\_

### Finishes

#### Door

- Natural Satin Anodized
- 313 Dark Bronze Anodized
- 315 Black Anodized
- Other \_\_\_\_\_

#### Housing

- Natural Satin Anodized
- 313 Dark Bronze Anodized
- 315 Black Anodized
- Other \_\_\_\_\_

#### Reveal

- Natural Satin Anodized
- 313 Dark Bronze Anodized
- 315 Black Anodized
- Other \_\_\_\_\_

### Continuous Angle / Trim

See Note 1

- Natural Satin Anodized
- 313 Dark Bronze Anodized
- 315 Black Anodized
- Other \_\_\_\_\_

### Special Comments

\_\_\_\_\_  
\_\_\_\_\_  
\_\_\_\_\_

### Component Information

See Notes 2, 4 & 5

- Single Component Configuration
- Multiple Component Configuration  
(Provide Format)

#### Header

- With Header
- Without Header

Size: H. \_\_\_\_\_ W. \_\_\_\_\_

### Directory

#### Informer Message Strips (Molded Plastic)

- I-50; 1/2" x 9"  
Color: \_\_\_\_\_ Total Qty.: \_\_\_\_\_
- I-100; 1" x 9"  
Color: \_\_\_\_\_ Total Qty.: \_\_\_\_\_

### Accord15™ SignBands

Part Code	Length	Color	Qty.

### Accord15™ SignBands w/ Paper Insert

Part Code	Length	Color	Qty.

### Maps or Plans

Size: H. \_\_\_\_\_ W. \_\_\_\_\_

### Magnetic Board

Size: H. \_\_\_\_\_ W. \_\_\_\_\_  
Color: \_\_\_\_\_

### Cork Board

Size: H. \_\_\_\_\_ W. \_\_\_\_\_  
Color: \_\_\_\_\_

### Fabric Board

Size: H. \_\_\_\_\_ W. \_\_\_\_\_  
Color: \_\_\_\_\_

### Custom Components

- Complete Specifications Provided

# Visuline® 2300.2 Series Full Recessed Display



## Installation / Mounting Details

### Section : Plan View

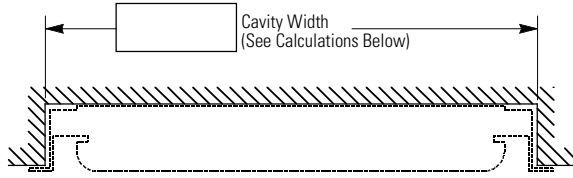

### IMPORTANT :

**APCO IS NOT RESPONSIBLE FOR CAVITY CONSTRUCTION WHICH VARIES FROM SPECIFICATIONS SHOWN ON THIS PAGE.**  
Cavity opening size must be precisely constructed in terms of both size and squareness. Size calculations and cavity opening tolerances are shown below.

### Elevation : Front View

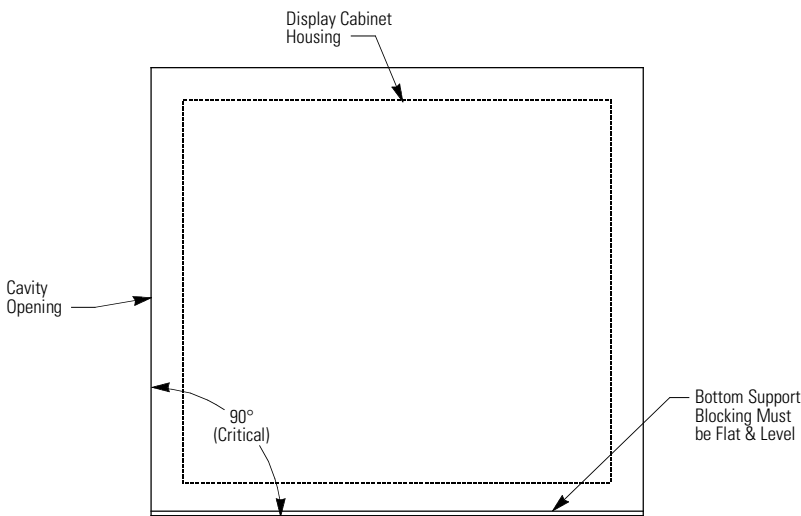

### Section : Side View

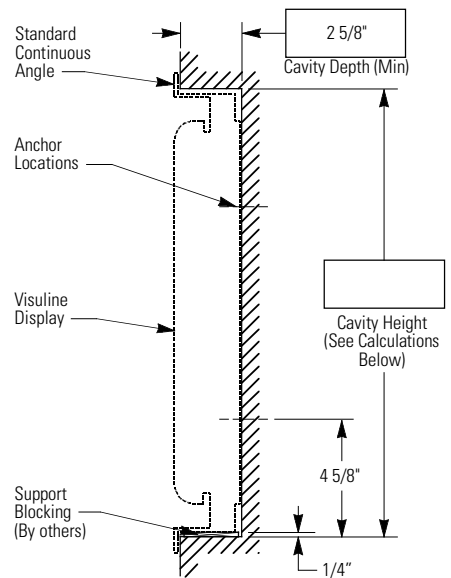

### Cavity Size : Standard

#### Continuous Angle

The Continuous Angle is recommended to conceal rough cut openings while allowing for inconsistencies in cavity size. It also helps to avoid obstruction of the reveal area which is required for proper door operation. To determine cavity opening, add 2-3/4" to both the cabinet's height and width.

$$\boxed{\text{Cabinet Height}} + 2\text{-}3/4" = \boxed{\text{Cavity Height}}$$

$$\boxed{\text{Cabinet Width}} + 2\text{-}3/4" = \boxed{\text{Cavity Width}}$$

These calculations include a 1" Reveal, 1/8" thick Continuous Angle and 1/4" installation clearance around full perimeter. **Overall cavity tolerance is +/- 1/8".**

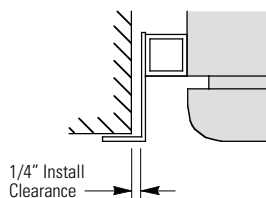

### Cavity Size : Optional

#### "Flat Bar" Trim

A 1/8" wide "Flat Bar" can be substituted when the 1" wide Continuous Angle is not desired. To determine cavity opening, add 2-3/8" to both the cabinet's height and width.

$$\boxed{\text{Cabinet Height}} + 2\text{-}3/8" = \boxed{\text{Cavity Height}}$$

$$\boxed{\text{Cabinet Width}} + 2\text{-}3/8" = \boxed{\text{Cavity Width}}$$

These calculations include a 1" Reveal, 1/8" thick Flat Bar and 1/16" installation clearance around full perimeter. **Overall cavity tolerance is +1/8", minus 0".**

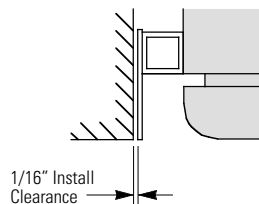

### Cavity Size : Optional

#### Angle / Trim Omitted

When cavity space is a factor, the surrounding trim can be eliminated to obtain the largest directory/cavity combination. The 1" reveal remains to maintain proper door operation. To determine cavity opening, add 2-1/8" to both the cabinet's height and width.

$$\boxed{\text{Cabinet Height}} + 2\text{-}1/8" = \boxed{\text{Cavity Height}}$$

$$\boxed{\text{Cabinet Width}} + 2\text{-}1/8" = \boxed{\text{Cavity Width}}$$

These calculations include a 1" Reveal and 1/16" installation clearance around full perimeter. **Overall cavity tolerance is +1/8", minus 0".**

