

# Visulite® 2210.2 Series

## Full Recessed Directory - Floating Glass



### SUBMITTED FOR APPROVAL

This product is scheduled for shipment the week of :

Date \_\_\_\_\_

Production cannot begin until one (1) copy of these drawings is returned with your signature of approval by :

Date \_\_\_\_\_, otherwise rescheduling will be necessary. Drawing revisions may also require rescheduling.

Retain \_\_\_\_\_ Set(s)

Return \_\_\_\_\_ Set(s)

### Customer Approval Required *(Check appropriate box)*

Purchaser \_\_\_\_\_

By (Print name & title clearly) \_\_\_\_\_

Signature \_\_\_\_\_ Date \_\_\_\_\_

Approved for Production

Approved as noted

Not approved  
Resubmit with changes  
Product subject to rescheduling

### FOR REFERENCE ONLY *(Customer Waives Approval)*

#### Production Has Begun

This product is scheduled for shipment the week of :

Date \_\_\_\_\_

It is understood that customer, in waiving formal approval procedure, assumes full responsibility for the specifications, dimensions and details included herein.

### APCO Use

Project Name \_\_\_\_\_ **APCO Order No.** \_\_\_\_\_

Customer Order No. \_\_\_\_\_

Original Submittal Date : \_\_\_\_\_

Prepared by (Print clearly) \_\_\_\_\_

Revision (Date) \_\_\_\_\_

All design rights reserved.

# Visulite® 2210.2 Series

## Full Recessed Directory - Floating Glass



### Product Details

#### Section : Plan View

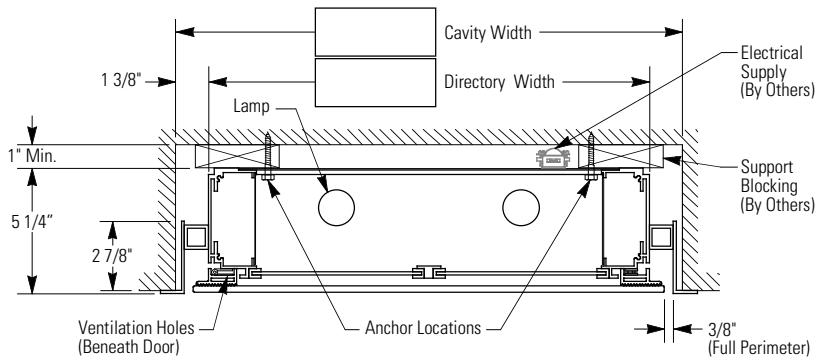

#### Cut-away Isometric View

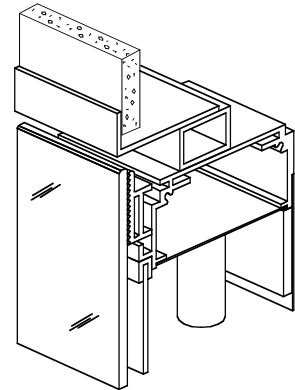

#### Elevation : Front View

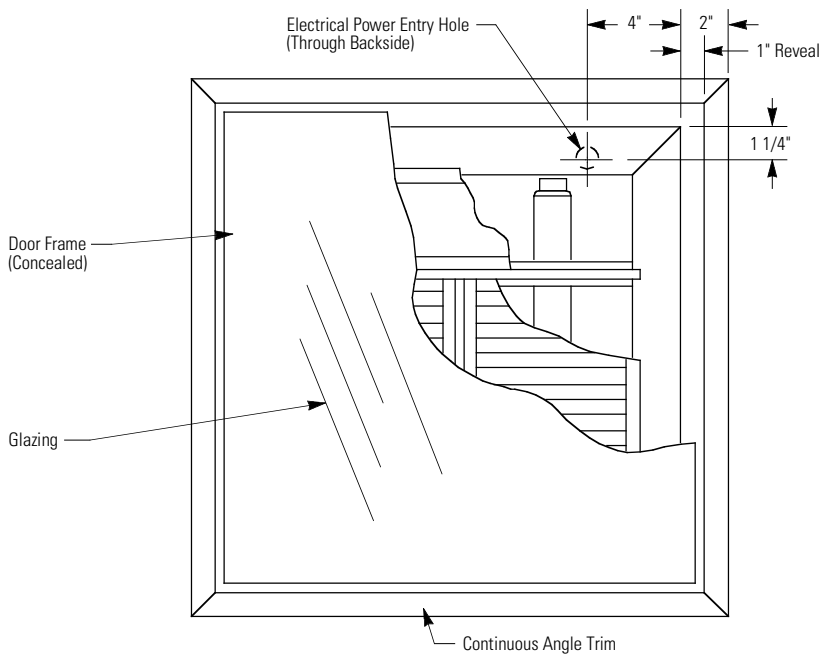

#### Section : Side View

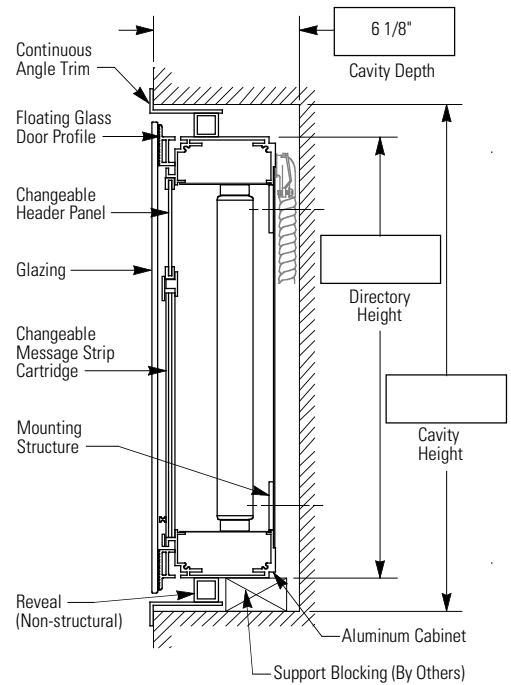

#### Door Profile

Extruded aluminum Floating Glass profile is available in 315 black anodized finish only.

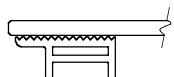

□ (FG)  
Floating Glass

Specifications for other available Door Profiles are illustrated on separate Shop Drawing 2210.2 Full Recessed.

#### Door Operating Clearance

A 1" wide Reveal (tube) is attached to the cabinet at a 1-7/8" depth to maintain proper door operation. A decorative, non-structural trim is then attached to the tube.

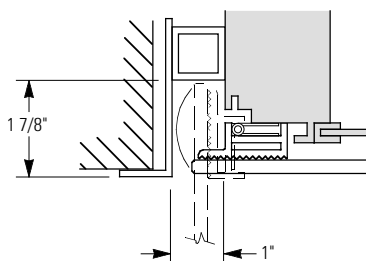

**IMPORTANT :**  
Because the Floating Glass Directory has a Frameless Door, the glass edges are exposed and are subject to damage if the directory is not mounted within a fully recessed cavity - either vertically within a wall or at an angle within a console.

See "Installation / Mounting Details" page to determine Cavity Dimensions.

# Visulite® 2210.2 Series

## Full Recessed Directory - Floating Glass



## Specifications

### Product

Size: H.\* \_\_\_\_\_ W. \_\_\_\_\_ D. 5-1/4"  
 Estimated Weight \_\_\_\_\_

### Cavity Opening Size

(See Note 1)

- Existing Cavity
- To Be Constructed

Size: H. \_\_\_\_\_ W. \_\_\_\_\_ D. 6-1/8"

### Door Frame Shape

- Floating Glass

Use separate Shop Drawing for all other door shapes

### Configuration

- A With Standard 4" Header
- B Without Header
- C Full Size Display (See Note 2)
- D Combination  
(Include all specifications)

### 1/2" Message Strip

/ Qty.

- NS-50; 1/2" x 7" / \_\_\_\_\_
- NS-35; 1/2" x 3-1/2" † / \_\_\_\_\_

No. of Columns \_\_\_\_\_

### 1" Message Strip

/ Qty.

- NS-100; 1" x 11" / \_\_\_\_\_
- NS-55; 1" x 5-1/2" †† / \_\_\_\_\_

No. of Columns \_\_\_\_\_

### Hinge Location

- Left
- Top  
(Opens approx. 60°, 75° or 90°,  
depending on door size)
- Other \_\_\_\_\_

### Door Locking Device

- 3M "Dual Lock" Fastener  
(Reveal space is limited to this method only)

### Glazing

- Tempered Glass - Graylite #14 (Standard)
- Mar-Resistant Lexan (G.E. MR10-7123)

### Continuous Angle / Trim

(See Note 1)

- 1" Wide Angle (Standard)
- 1/8" Wide "Flat Bar" Trim
- Omit Angle / Trim (1" Reveal Remains)
- Other \_\_\_\_\_

### Electrical

#### Voltage

- 120V, 60Hz (Standard)
- 277V, 60Hz

Amperage \_\_\_\_\_

#### Power Entry

- Upper Right Corner Thru Backside (Standard)
- Other \_\_\_\_\_  
(Show on "Product Details" page)

#### Lamps

Type \_\_\_\_\_  
 Quantity \_\_\_\_\_

### Finishes

#### Housing

- 315 Black Anodized (Standard)
- Other \_\_\_\_\_

#### Reveal

- 315 Black Anodized (Standard)
- Other \_\_\_\_\_

#### Continuous Angle / Trim

(See Note 1)

- Natural Satin Anodized
- 313 Dark Bronze Anodized
- 315 Black Anodized
- Other \_\_\_\_\_

### Special Comments

---

---

---

---

---

---

---

---

### Note 1

Wall cavity size is determined by adding cabinet housing, surrounding reveal, trim and installation clearance. Trim styles and cavity opening calculations for each are illustrated on "Installation / Mounting Details" page.

### Note 2

Dimensions for determining illuminated area are calculated by subtracting 4-3/8" from both the directory's standard height\* and width.

Height \_\_\_\_\_ - 4-3/8" = \_\_\_\_\_ (Illuminated Area)      Width \_\_\_\_\_ - 4-3/8" = \_\_\_\_\_ (Illuminated Area)

† NS35 copy length is 2-1/4". Copy height is limited to 1/8" (approximately 23 characters.)

†† NS55 copy length is 4-3/16". Copy height should be specified to fit within this area.

\* Standard directory heights are based on available lamp lengths.

# Visulite® 2210.2 Series Full Recessed Directory - Floating Glass



## Installation / Mounting Details

### Section : Plan View

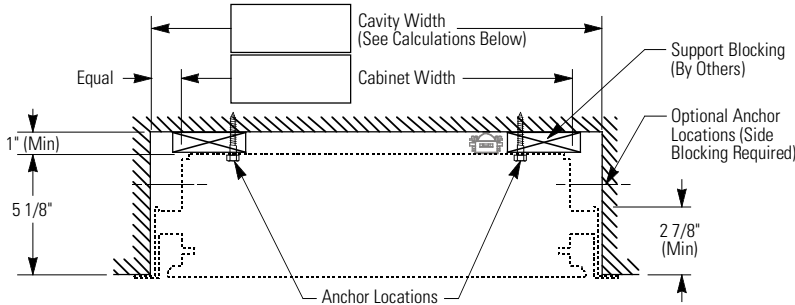

**IMPORTANT :**  
APCO IS NOT RESPONSIBLE FOR CAVITY CONSTRUCTION WHICH VARIES FROM SPECIFICATIONS SHOWN ON THIS PAGE. Cavity opening size must be precisely constructed in terms of both size and squareness. Size calculations and cavity opening tolerances are shown below for each trim style.

### Elevation : Front View

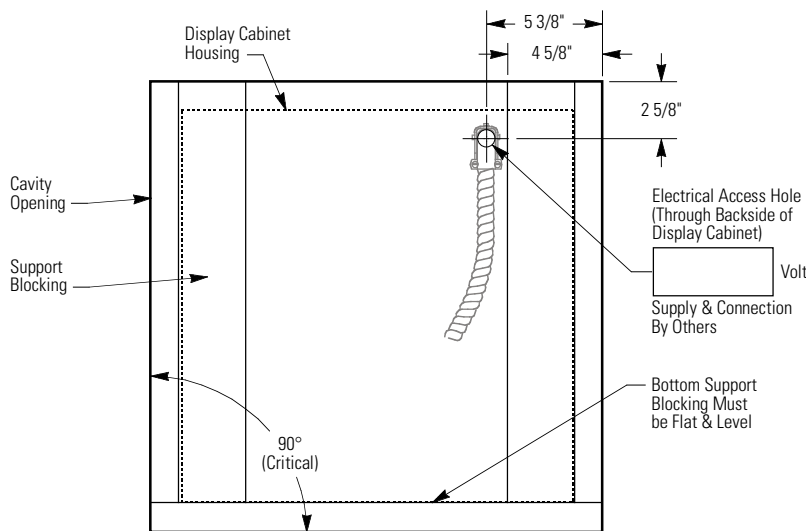

### Section : Side View

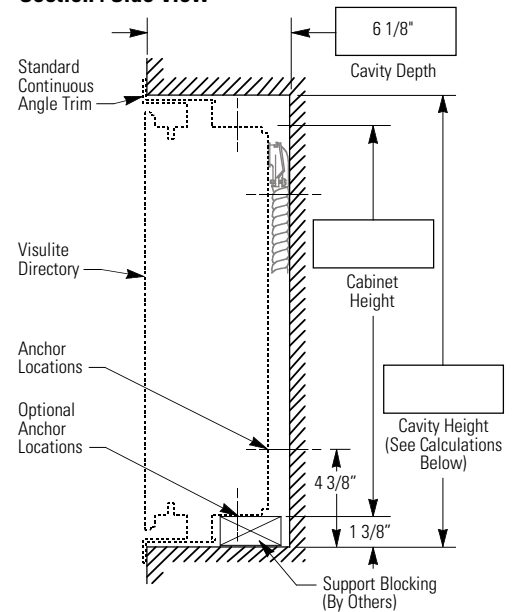

### Cavity Size : Standard

#### Continuous Angle

The Continuous Angle is recommended to conceal rough cut openings while allowing for inconsistencies in cavity size. It also helps to avoid obstruction of the reveal area which is required for proper door operation. To determine cavity opening, add 2-3/4" to both the cabinet's height and width.

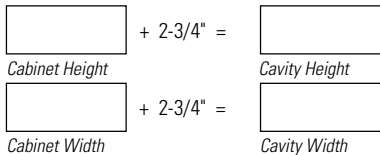

These calculations include a 1" Reveal, 1/8" thick Continuous Angle and 1/2" total installation clearance.  
**Overall cavity tolerance is +/- 1/8".**

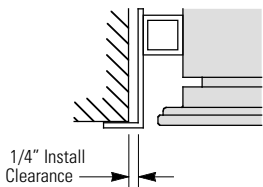

### Cavity Size : Optional

#### "Flat Bar" Trim

A 1/8" wide "Flat Bar" can be substituted when the 1" wide Continuous Angle is not desired. To determine cavity opening, add 2-3/8" to both the cabinet's height and width.

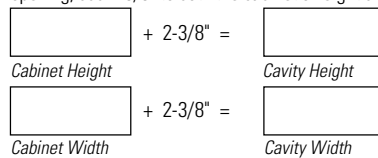

These calculations include a 1" Reveal, 1/8" thick Flat Bar and 1/8" total installation clearance.

**Overall cavity tolerance is +1/8", minus 0".**

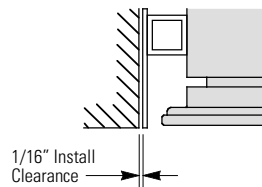

### Cavity Size : Optional

#### Angle / Trim Omitted

When cavity space is a factor, the surrounding trim can be eliminated to obtain the largest directory/cavity combination. The 1" reveal remains to maintain proper door operation. To determine cavity opening, add 2-1/8" to both the cabinet's height and width.

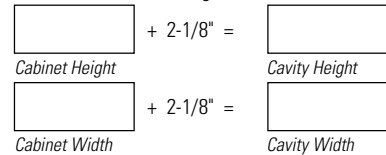

These calculations include a 1" Reveal and 1/8" total installation clearance.

**Overall cavity tolerance is +1/8", minus 0".**

